

# Installation Manual

## FD35SP SLIDING DOOR SYSTEM

LAMP®

Recessed Mount Roller

Part No. : FD35SPHHP

Thank you for using our product. Before installation, please read this manual thoroughly to ensure correct installation. Please keep this manual at hand for future reference.

### ABOUT THE PRODUCT

- This is a parts set for a sliding door system for residential & commercial use.
- The door can be installed without the use of tools.

### SPECIFICATIONS

Door height	Max. 2400 mm	2401 - 2700 mm
Door width	Max. 1200 mm	700 - 1200 mm
Min. Door thickness	24 mm	
Max. Door weight	35 kg	
Vertical adjustment	± 4 mm	
Depth adjustment	± 2 mm	

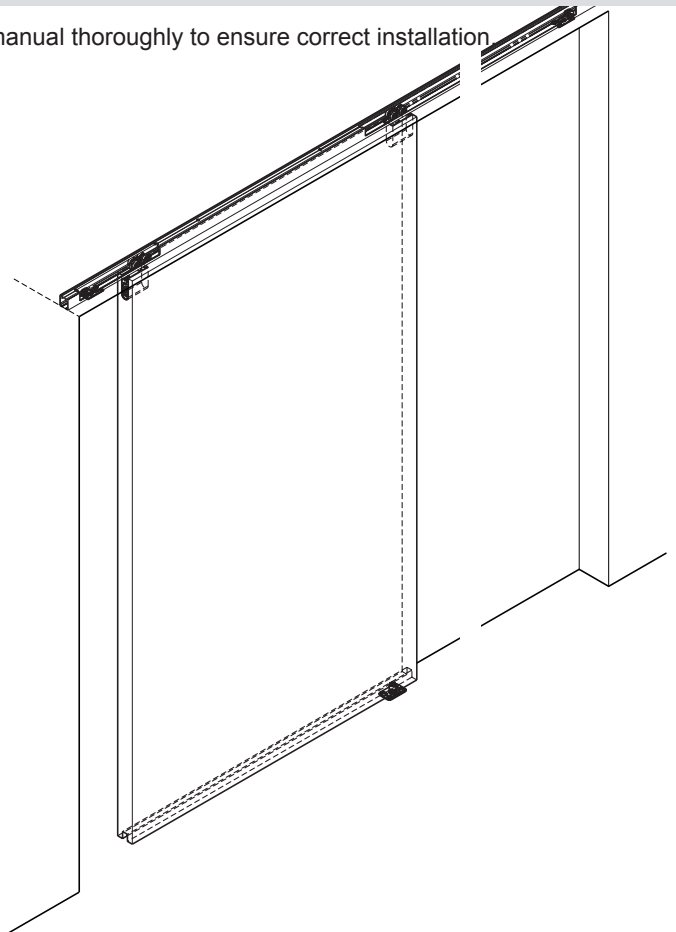

### FOR YOUR SAFETY AND CORRECT INSTALLATION

 **Warning Caution**    **Prohibited**    **Required**

#### WARNING: If not followed, death or serious injury may result.



- This product should be installed by a qualified person in accordance with this manual. If it is not installed correctly, the door may fall and cause injury.
- Provide a frame that can withstand the weight and impact of opening and closing the door. Be sure to use the specified screws and tighten them securely. If the mounting strength is insufficient, the door may fall and cause injury.



- Do not use this product for any other purpose, or with doors that are outside the specifications of this manual.
- Do not disassemble or modify any parts other than those described in this document.

#### Caution: If not followed, injury or damage may result.



- Follow the specified dimensions, specifications, and alignment of the door and frame. Warping, tilting or twisting of the frame or door may cause failure.
- If cutting any parts, make sure to remove any burrs before installation. Also check the upper track for any left-over burrs or scraps and remove these.
- This product is a part for architectural fittings. After installation, please check the function and safety of the final product. Please inform the end user how to use the product safely.
- Make sure to check the screws for slack at regular intervals (one month from first usage, half a year, and then one time every year is recommended).
- Install the product with two people (in the case of one person, there is a risk of damaging components).

# COMPONENT PARTS

No.	①		②	③	④
Name	Upper track (surface mount)	Upper track (recessed mount)	Upper roller	Upper catch	Floor guide
Item No.	FD35EV-TRM	FD35EV-TRH	FD35SP-WRH	FD30-HTST	FD50-BGR18
Item	<p>Without trigger</p> <p>either one Hole pitch : 300 mm Pitch end : 30 mm</p>		<p>Without nut</p> <p>2 pcs</p>	<p>2 pcs</p>	<p>1 pc</p>
Accessories	—	—	Flat head tapping screw 3.8 × 40 ..... 6 pcs	—	Countersunk head tapping screw 4 × 20 ..... 4 pcs
Remarks	Recommended screw: Countersunk head tapping screw 3.5 × 25		—	—	—

OPTIONAL PARTS	No.	⑤	⑥	ACCESSORY	⑦
	Name	Embedded Lower Guide Rail	Cover cap		Spanner wrench
	Item No.	FD30-HBRT	FDSP-WRH-CP		FDSP-SP
	Item	<p>1000 - 1500 mm</p> <p>Hole pitch : 250 mm Pitch end : 30 mm</p>			
	Accessories	—	—		—
Remarks	Recommended screw: Countersunk head tapping screw 4 × 20		—	—	

## INSTALLATION DRAWING (EXAMPLE)

In this manual, a single sliding door is used as an example.

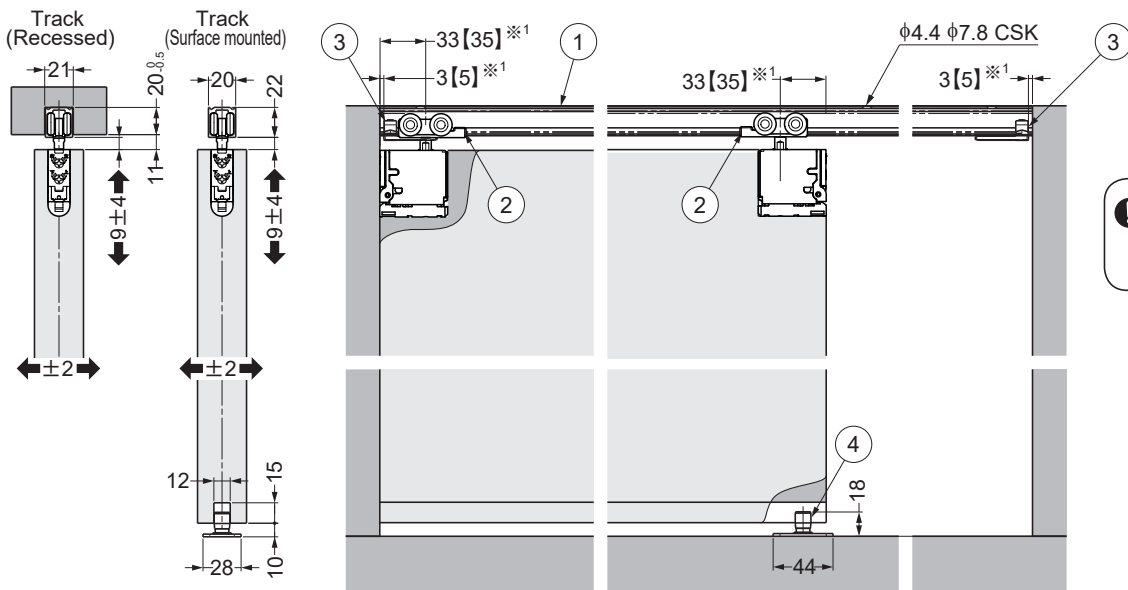

**CAUTION**  
 ⚠ When a vertical frame is not used, apply a two-way soft closer.

\*1 [ ] : When cover cap ⑥ (option) is used.

Door process dimension

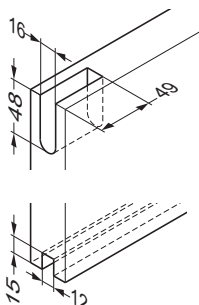

\*1 When using cover cap ⑥

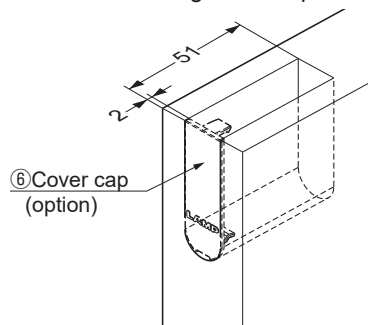

When using door guide track

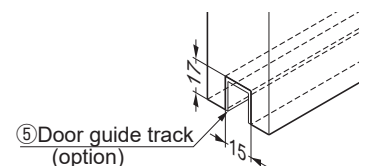

## 1 Cutting and Hole Drilling on Upper Track

**CAUTION**  
When cutting, reinforce the track to prevent deformation at the cut section.

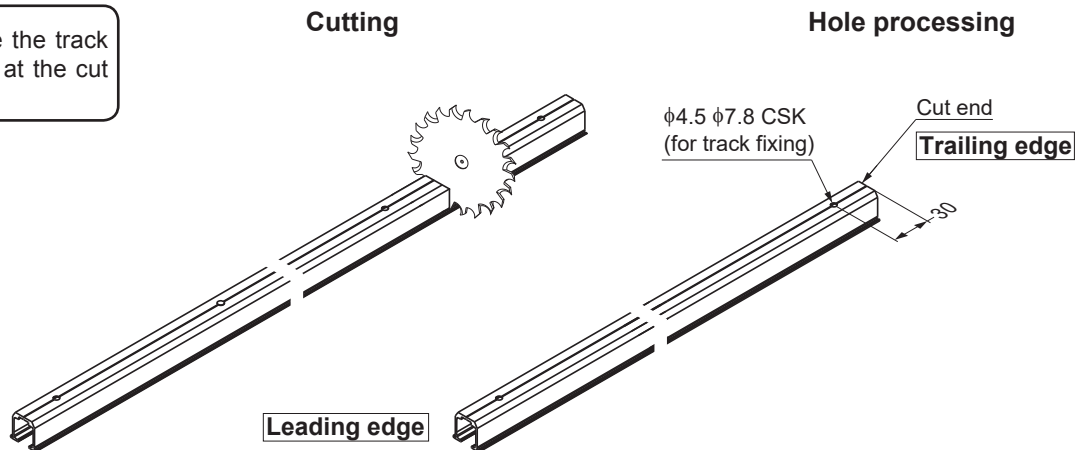

## 2 Preparation of Mounting Parts

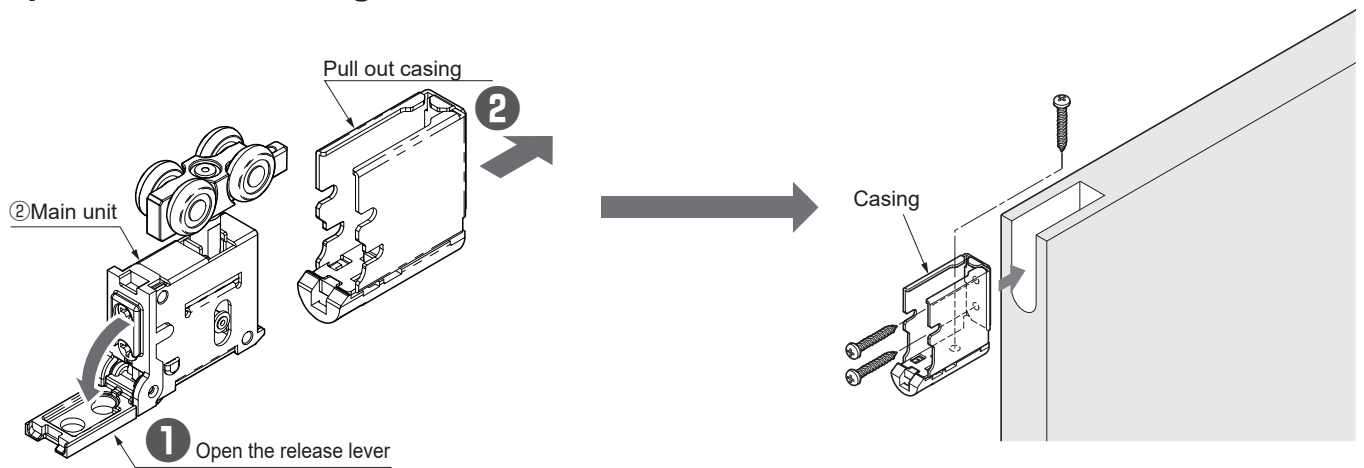

## 3 Inserting Parts into Upper Track

Insert the parts in order from ① to ④ with care of direction.

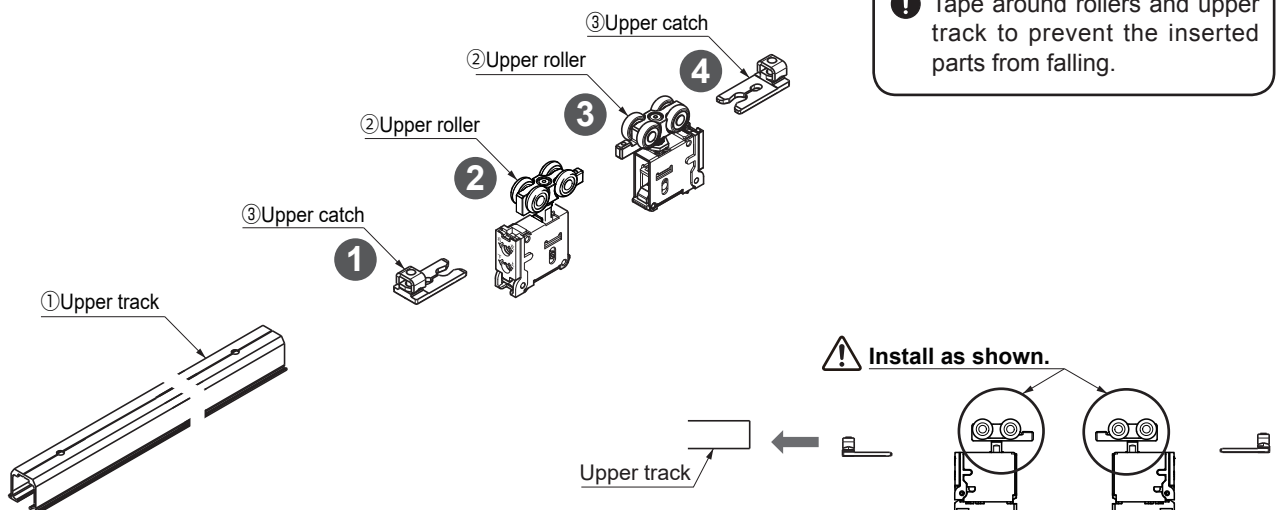

## 4 Mounting of Upper Track

(Recommended screw: Countersunk head tapping screw 3.5x25)

### CAUTION

- ❗ Be careful not to overtighten the screws and screw heads protruding on upper track.
- ⊘ It may cause deformation of track or damage of soft closer.

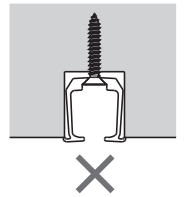
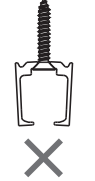

inclined

loosen

overtightened

deeper groove

## 5 Mounting of Floor Guide Temporarily

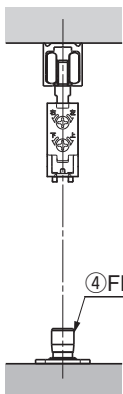

Position the floor guide below the center of the upper track so that it is covered by the door when it is opened and closed.

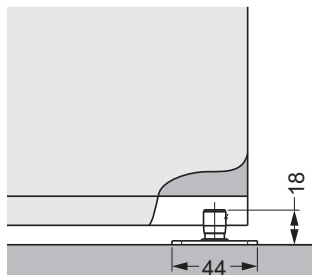

④ Floor Guide

Temporarily fasten through the slotted holes with the provided screws.

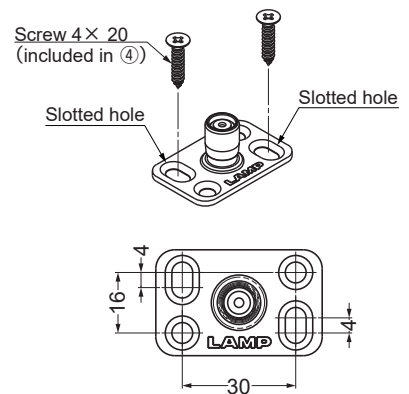

## 6 Hanging Door

- ① Place a 10 mm support under the door.
- ② While holding the door, place the groove under the door on the protruding part of the floor guide.

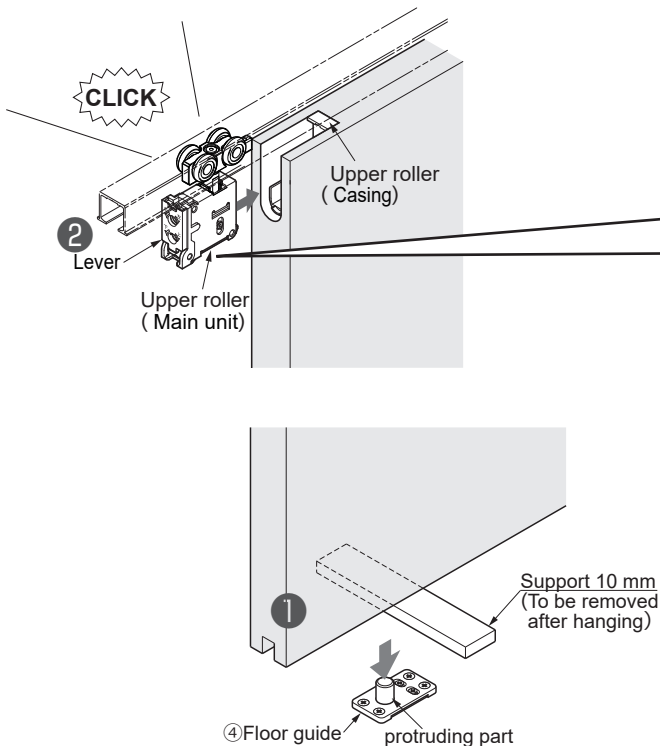

### CAUTION

Verify that the main unit is not dislocated from the casing, either of the door ends.

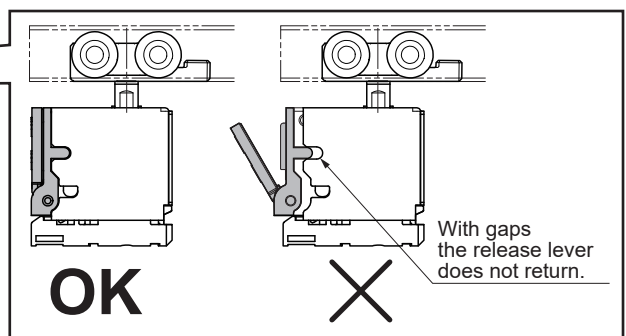

## 7 Adjusting the Door Position

Adjust the door parallel to the upper track with 6 – 14 mm of clearance between the door and floor.

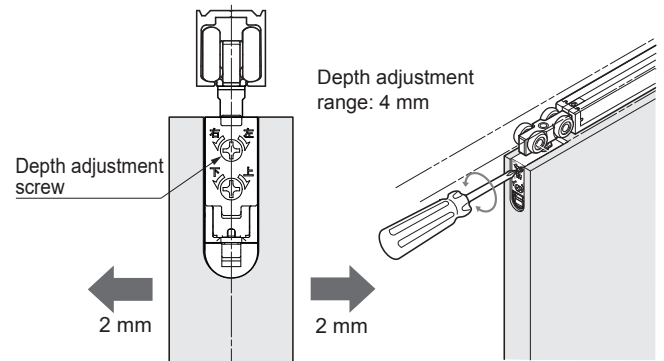
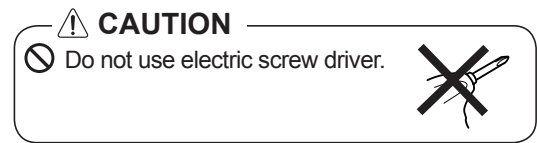
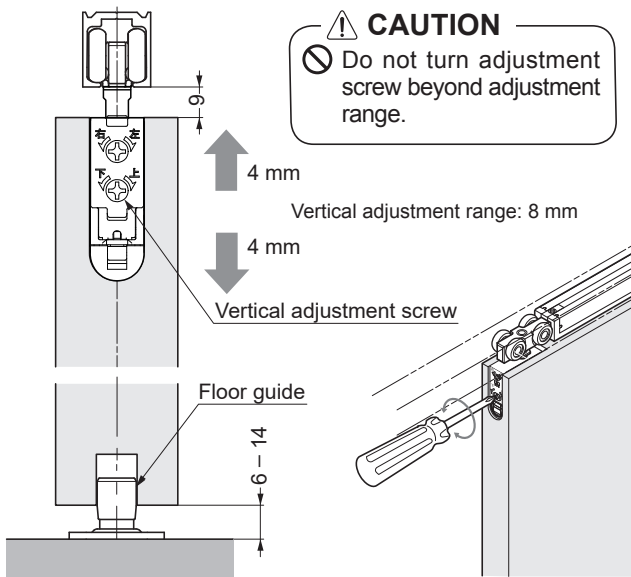

## 8 Adjusting, Fastening the Floor Guide

If the door movement is not smooth, remove the door, then adjust the floor guide forwards or backwards.

Tighten all 4 screws after the adjustment.

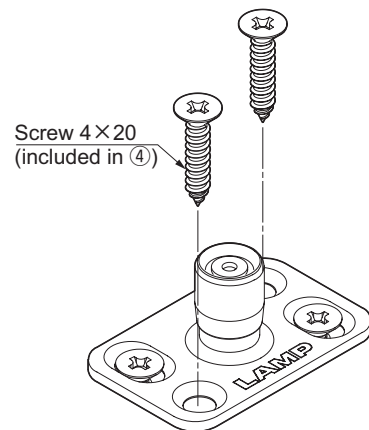
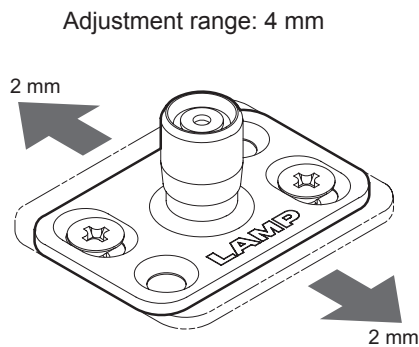

## 9 Fixing the End Catch Position

Fix the end catch 3 mm (※<sup>2</sup>) from the position where door stops.  
Adjust the position of the end catch where it catches the hanger bolt of the roller when the door is stopped by the frame or door stopper.  
※<sup>2</sup> When using cover caps ⑥, it is 5 mm.

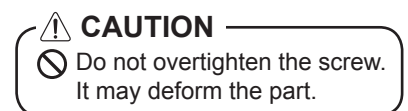
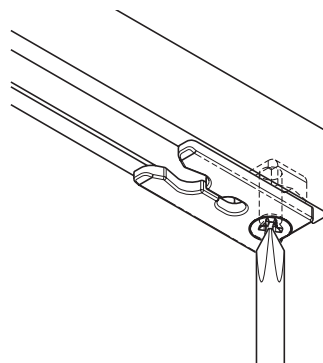
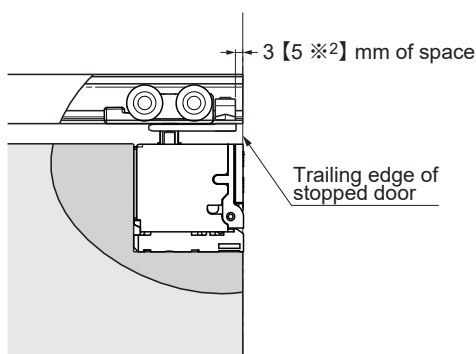

## APPENDIX 1 How to remove door

- Use a 10 mm support under the door.
- Then pull out the upper roller main unit from the door while lower the lever.
- It will be easier if you slide the hanger bolt with a spanner wrench.

### CAUTION

Be careful not to let the door fall.

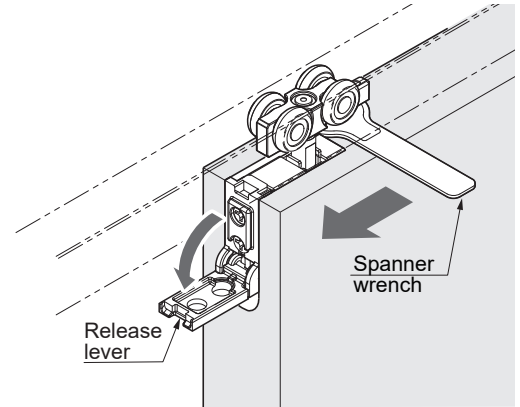

### PERIODICAL INSPECTION

- Clean the inside of the track.
- Check the upper and lower space of the door. If necessary, correct the space.

## TROUBLESHOOTING

Trouble	Checkpoint	Solution
Abnormal noise during operation	Check if door bottom contacts the floor or floor guide.	Verify that the track fixing screws are not loosened. Then, adjust the door height such that the clearance between the door bottom and floor is 6 – 14 mm.
	Check if door touches adjacent parts.	Adjust the door depth position to avoid contact with other objects or adjust the position of floor guide.
	Check track rollers for aluminum dust.	Remove the track, then pull out and clean the roller.
	Check the track retaining screws for looseness.	Retighten screws to free the roller.
Heavy door operation	Check if door bottom contacts the floor or floor guide.	Verify that the track mounting screws are not loosened. Then, adjust the door height such that the clearance between the door bottom and floor is 6 - 14 mm.
	Check if door touches adjacent parts.	Adjust the door depth position to avoid contact with other objects or adjust the position of floor guide.
Door does not move.	Check the track retaining screws for looseness.	Retighten screws to free the roller.
Door starts to move.	Check if the upper track is set horizontally.	Using a level gauge, reset the upper track horizontally.
End catch does not work properly.	Check if roller is installed correctly.	If a roller for the two-way soft closer (FD35SP-WRH) is installed by mistake, the jump prevention nut on the roller will interfere with the end catch. Replace it with the correct roller.

**SUGATSUNE KOGYO CO., LTD.**  
Tokyo, JAPAN  
Phone: +81 3 3866 2260  
E-mail: export@sugatsune.co.jp

**SUGATSUNE KOGYO (UK) LIMITED**  
Reading, UK  
Phone: +44 1189 272 955  
E-mail: sales@sugatsune.co.uk

**SUGATSUNE EUROPE GmbH**  
Düsseldorf, GERMANY  
Phone: +49 211 53812 900  
E-mail: sales@sugatsune.eu

**SUGATSUNE AMERICA, INC.**  
California, USA  
Phone: +1 310 329 6373  
E-mail: sales@sugatsune.com

**Chicago, USA**  
Phone: +1 630 317 7072  
E-mail: sales@sugatsune.com

**SUGATSUNE CANADA, INC.**  
Montreal, CANADA  
Phone: +1 514 312 5267  
E-mail: support@sugatsune.ca

**SUGATSUNE SHANGHAI CO., LTD.**  
Shanghai, CHINA  
Phone: +86 21 3632 1858  
E-mail: lamp@sugatsune.com.cn

**Guangzhou, CHINA**  
Phone: +86 20 6639 3554  
E-mail: lamp@sugatsune.com.cn

**SUGATSUNE KOREA CO., LTD.**  
Incheon, KOREA  
Phone: +82 32 220 0603  
E-mail: sales@sugatsune-korea.co.kr

**SUGATSUNE KOGYO INDIA PRIVATE LIMITED**  
Mumbai, INDIA  
Phone: +91 9867299597  
E-mail: sales@sugatsune.in  
**Delhi, INDIA**  
Phone: +91 9867299597  
+91 11 45093636  
E-mail: sales@sugatsune.in