

Installation Manual

FD50SP SLIDING DOOR SYSTEM

LAMP®

Recessed Mount Roller, Two-Way Soft Close

Part No. : FD50SPDHCP

Thank you for using our product. Before installation, please read this manual thoroughly to ensure correct installation. Please keep this manual at hand for future reference.

ABOUT THE PRODUCT

- This product is a parts set for an indoor sliding door system for residential & commercial use.
- Built in soft closer enables two-way soft closing movement in both directions.
- The door can be installed without the use of tools.

SPECIFICATION

| | | |
|---------------------|---------------|----------------|
| Door height | Max.2400 mm | 2401 - 2700 mm |
| Door width | 680 - 1500 mm | 800 - 1500 mm |
| Min.Door thickness | 24 mm | |
| Max.Door weight | 50 kg / door | |
| Vertical adjustment | ± 4 mm | |
| Depth adjustment | ± 2 mm | |

- The closing speed of the soft closing type door may change depending on the ambient temperature, operating method or installation quality.
- Recommended ambient temperature range is 5 to 40 °C .

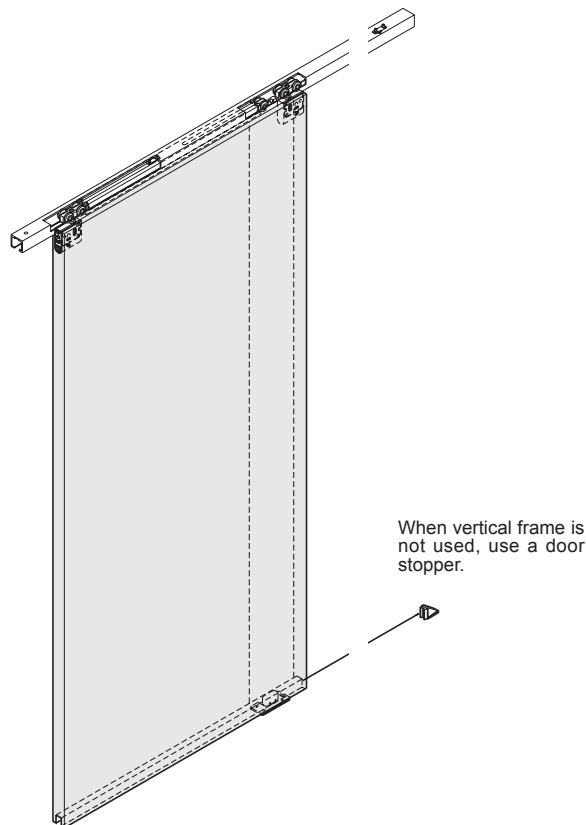

FOR YOUR SAFETY AND CORRECT INSTALLATION

 **Warning Caution**  **Prohibited**  **Required**

WARNING: If not followed, death or serious injury may result.



- This product should be installed by a qualified person in accordance with this manual. If it is not installed correctly, the door may fall and cause injury.
- Provide a frame that can withstand the weight and impact of opening and closing the door. Be sure to use the specified screws and tighten them securely. If the mounting strength is insufficient, the door may fall and cause injury.



- Do not use this product for any other purpose, or with doors that are outside the specifications of this manual.
- Do not disassemble or modify any parts other than those described in this document.

Caution: If not followed, injury or damage may result.



- Follow the specified dimensions, specifications, and alignment of the door and frame. Warping, tilting or twisting of the frame or door may cause failure.
- If cutting any parts, make sure to remove any burrs before installation. Also check the upper track for any left-over burrs or scraps and remove these.
- This product is a part for architectural fittings. After installation, please check the function and safety of the final product. Please inform the end user how to use the product safely.
- Make sure to check the screws for slack at regular intervals (one month from first usage, half a year, and then one time every year is recommended).
- Install the product with two people (in the case of one person, there is a risk of damaging components).

COMPONENT PARTS

| No. | ① | ② | ③ ④ | ⑤ | ⑥ | ⑦ | ⑧ | |
|-----------------|--|--|--|--|---|---|---------------|--|
| Name | Upper track | Soft closer (two-way) | Trigger, Jig | Upper roller | Floor guide S | Embedded Lower Guide Rail | Stopper block | |
| Item No. | FD50-TRM | FD50SP-WRH-DSC | FD50-TRG, FD50-TRJ | FD50SP-WRH | FD50-BG18 | FD30-HBRT | FD50-HSB | |
| Item | Hole pitch : 300 mm Pitch end : 30 mm Accessory screw: Flat fillister head tapping screw 3.8 X 40 | Accessory screw: Flat head tapping screw 3.8 X 40 3 pcs | ③ Trigger 2 pcs ④ Jig 1 pc Accessory screw: Flat head tapping screw (Countersunk head diameter 6) 4 X 30 4 pc | Accessory screw: Flat head tapping screw 3.8 X 40 3 pcs | Accessory screw: Binding head tapping screw 4 X 16 5 pcs | Hole pitch : 250 mm Pitch end : 30 mm Accessory screw: Countersunk head tapping screw 4 X 20 | | |
| Single sliding | 1 pc | 1 pc | 1 set | 1 pc | 1 pc | 1 pc | — | |
| Double sliding | 2 pcs | 2 pcs | 2 sets | 2 pcs | 2 pcs | 2 pcs | — | |
| In line sliding | 1 pc | 2 pcs | 2 sets | 2 pcs | 2 pcs | 2 pcs | 1 pc | |

| OPTIONAL PARTS | No. | ⑨ | ⑩ | ⑪ |
|----------------|----------|----------------------|--|----------------|
| | Name | Cover cap | Door stopper (floor mount) | Spanner Wrench |
| | Item No. | FD25SP-WRH-CP | FD30-HTKY | FD25SP-SP |
| | Item | Thickness : 2 mm | Accessory screw: Bind head tapping screw 4 X 30 3 pcs | |

INSTALLATION DRAWING (EXAMPLE) In this manual, a single sliding door is used as an example.

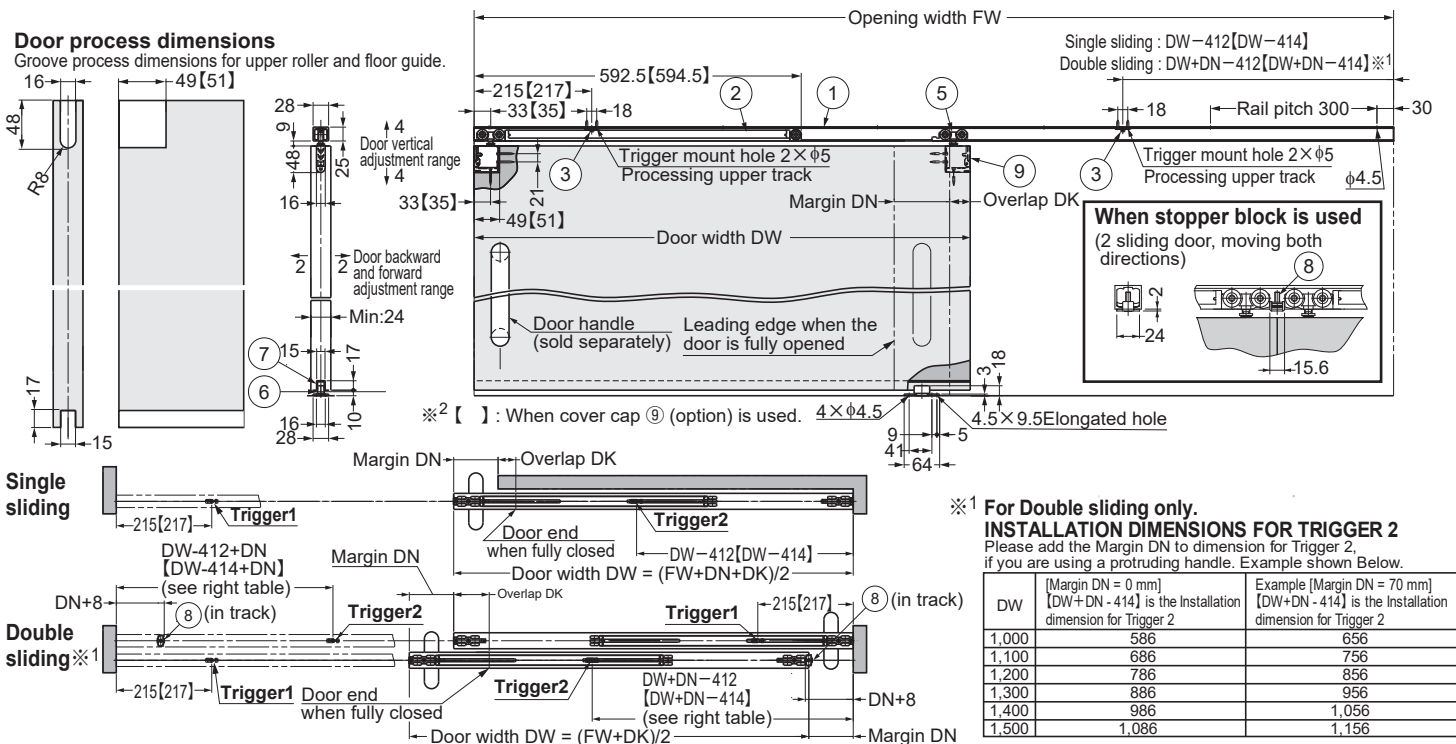

INSTALLATION PROCEDURE In this manual, a single sliding door is used as an example.

1 Preparation and Installation

[1] Cutting track and Hole Drilling on Upper Track

CAUTION

- When cutting, reinforce the track to prevent deformation at the cut section.
- Remove any dirt or aluminum chips from the track.

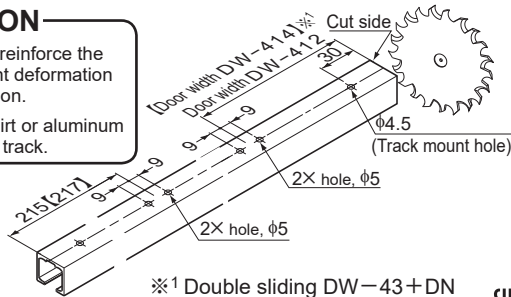

[2] Mounting Parts on Door

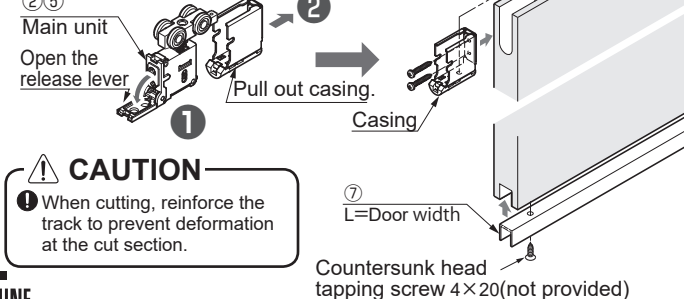

[3] Verification before installing soft closer

CAUTION
 Without verification, the self closing feature may fail.

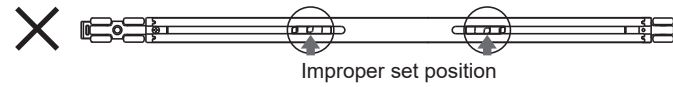
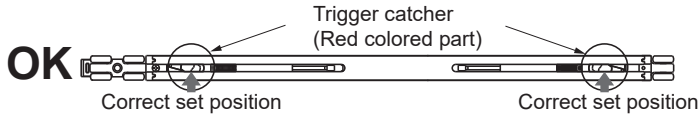

If the trigger position is wrong, pull back the trigger catcher to the correct position using a 6mm diameter round bar.



[4] Inserting parts into Upper Track

Insert the parts in order from ① to ② with care of direction.

CAUTION
 Tape around rollers and upper track to prevent the inserted parts from falling.

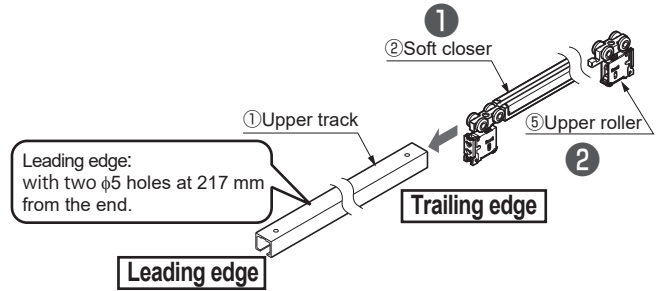

[5] Mounting of Upper Track

Take care of the direction of upper track (leading edge, trailing edge)

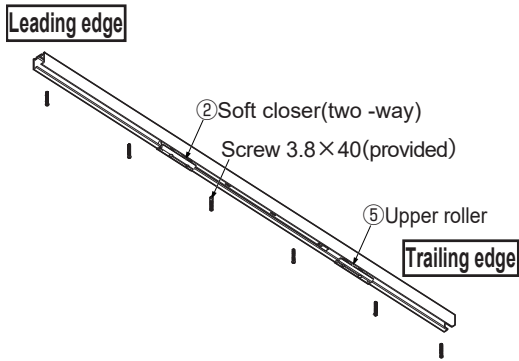

CAUTION
 Remove any dirt or aluminum chips from the track.
 Be careful not to over tighten the screws and screw heads protruding on upper track.

[6] Fastening of trigger

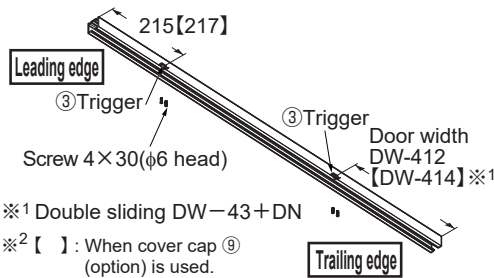
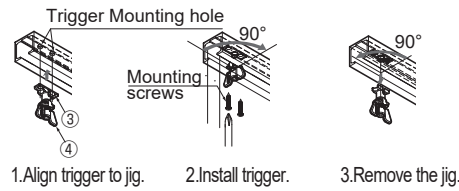

※1 Double sliding DW-43+DN
 ※2 []: When cover cap ⑨ (option) is used.

[7] Mounting of Floor Guide

- Position floor guide just below the center of the upper track.
- Position the floor guide so that its protruding part stays under the door when it is opened/closed.

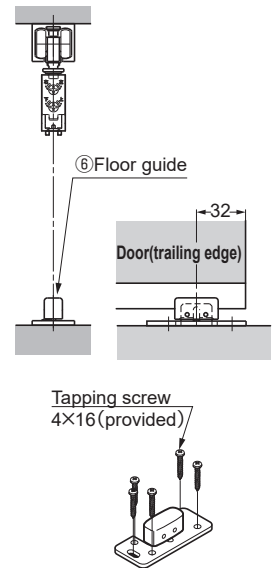

2 Hanging the Door and Adjustment

[1] Hanging (Bottom part)

Place a 10 mm support under the door. While holding the door, place the groove under the door on the protruding part of the floor guide.

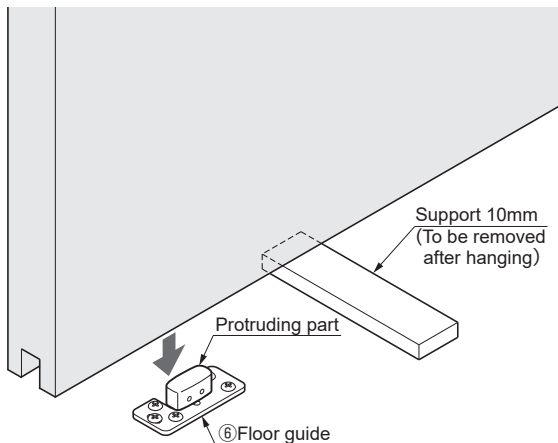

[2] Hanging (Top part)

Insert the upper roller into casing, until a "click" sound is heard.

CAUTION
 Verify that the main unit is not dislocated from the casing either of the door ends.

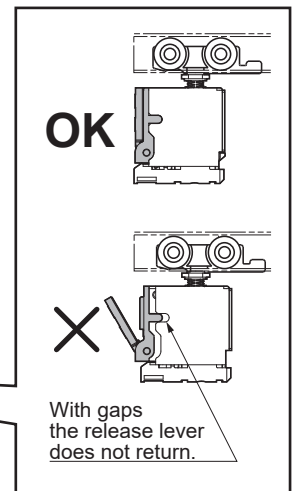
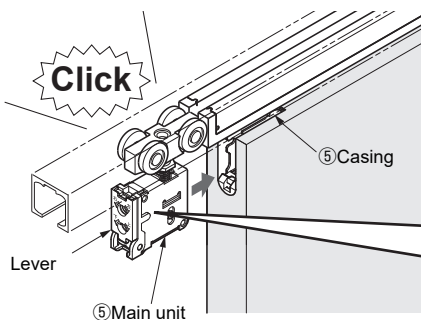

[3] Verification of soft closer operation

- (1) Remove the support from under the door.
- (2) Close the door slowly and check that the soft closer works correctly.
- (3) The soft closer is engaged approximately 115 mm before the door reach its final position.
- (4) Carry out similar verification for the door trailing edge. Please refer to the "troubleshooting section" when the soft closer does not work correctly.

CAUTION

- Do not close the door with excessive force. It may cause damage or malfunction of soft close mechanism.

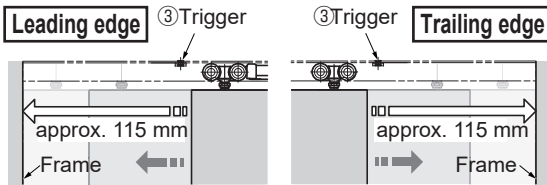

[4] Adjusting the Door Position

Adjust the door so that it is parallel to the upper track with 6- 14 mm of clearance between the door and floor.

CAUTION

- The adjustment of the door should be done with the jump prevention nut loosened.
- Do not turn adjustment screw beyond adjustment range.

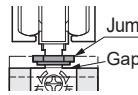

- Do not use electric screw driver.

Vertical adjustment range : 8 mm

Depth adjustment range : 4 mm

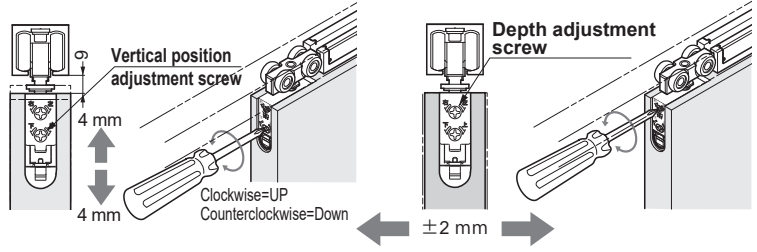

[5] Fastening the Jump Prevention Nut

The jump prevention nut is on the hanger bolt of the upper roller. Tighten the nut with the 12 mm spanner (sold separately) until it contacts the soft closer.

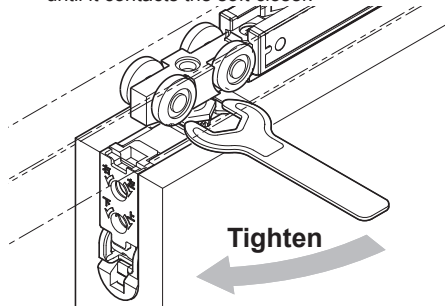

When vertical frame is not used, use the door stopper.

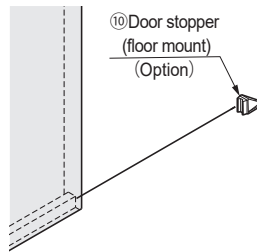

How to Remove Door

Use a 10 mm support under the door.

Then pull out the upper roller main unit from the door while lower the lever.

If it is difficult to install or detach the roller, loosen the nut as shown in the illustration.

It will be easier if you slide the hanger bolt with a spanner wrench.

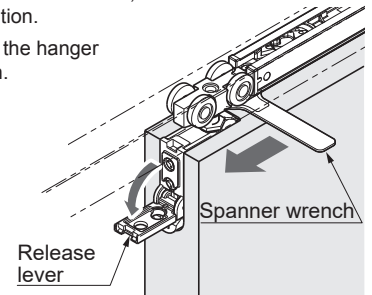

PERIODICAL INSPECTION

- Clean inside of track.
- Check the upper space and lower space of the door. If necessary, correct the space.

TROUBLESHOOTING

| Trouble | Check Point | Solution |
|---------------------------------|---|--|
| Door stops during soft closing | Check if door bottom contacts the floor. | Verify that the track mounting screws are not loosened. Then, adjust the door height such that the clearance between the door bottom and floor is 6 - 14 mm. |
| | Check if the upper track is set horizontally. | Using a level gauge, reset the upper track horizontally. |
| The door doesn't close softly | Check if mohair seal is installed. | Reduce the friction between the mohair seal and door. |
| | Check if trigger is installed. | Install trigger to specified position. |
| Abnormal noise during operation | Check if door is closed by excessive force. | Do not close door by excessive force as it may damage the soft closer. |
| | The position of the trigger catcher in page 3 section ■. [3] may become dislocated. (It is hidden as installed in upper track.) | Remove the door and the upper track, then check the status of the trigger catcher in section ■. [3] . |
| | Check if door bottom contacts the floor or floor guide. | Verify that the track mounting screws are not loosened. Then, adjust the door height such that the clearance between the door bottom and floor is 6 - 14 mm. |
| | Check if door touches adjacent parts. | Adjust the door depth position to avoid contact with other objects or adjust the position of floor guide. |
| Heavy door operation | Check track rollers for aluminum dust. | Remove the track, then pull out and clean the roller. |
| | Check the track mounting screws for looseness. | Retighten the screws to free the roller. |
| | Check if door bottom contacts the floor or floor guide. | Verify that the track fixing screws are not loosened. Then, adjust the door height such that the clearance between the door bottom and floor is 6 - 14 mm. |
| Door does not move. | Check if door touches adjacent parts. | Adjust the door depth position to avoid contact with other objects or adjust the position of floor guide. |
| | Check the upper track retaining screws for looseness. | Retighten the screws to free the roller. |
| Door starts to move. | Check if the upper track is set horizontally. | Using a level gauge, reset the upper track horizontally. |