

Installation Manual

FD50SP SLIDING DOOR SYSTEM

Recessed Mount Type for Pocket Door, with Two-way Soft Close

LAMP®

Part No. : FD50SPDHCP-PD

Thank you for selecting our product. Before starting installation, please read this manual thoroughly to ensure correct installation. Please keep this manual at hand for future reference.

ABOUT THE PRODUCT

- This is a parts set for sliding door system for residential & commercial use.
- Built in soft closer enables two-way soft closing movement in both direction.
- Two sections of track for easy maintenance after installing.

SPECIFICATIONS

Door height	Max. 2400 mm	2401 - 2700 mm
Door width	680 - 1500 mm	800 - 1500 mm
Min. Door thickness	30 mm	
Max. Door weight	50 ※ ¹ kg/door	
Vertical adjustment	± 4 mm	
Depth adjustment	± 2 mm	

- The closing speed of the soft closing type door may change depending on the ambient temperature, operating method or installation quality.
- Recommended ambient temperature range is 5 to 40°C .

※¹ When using a light weight door, you may feel the resistance of the soft closer when opening the door. (Recommended at least 25kg)

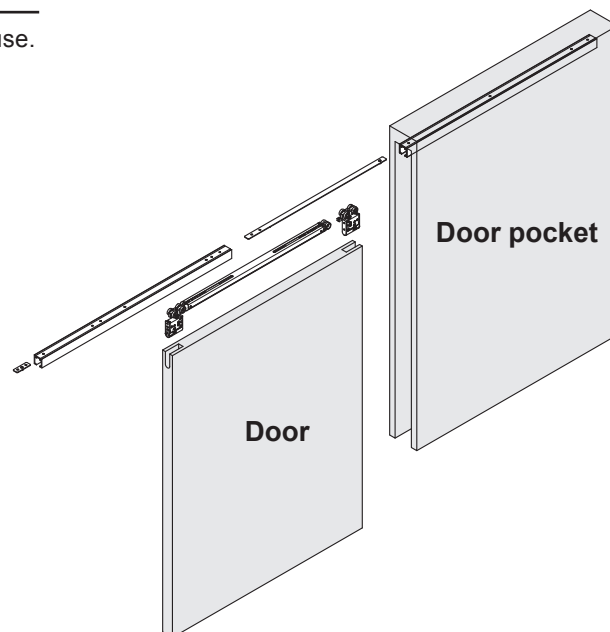

FOR YOUR SAFETY AND CORRECT INSTALLATION



Warning
Caution



Prohibited



Required

WARNING: If not followed, death or serious injury may result.



- This product should be installed by a qualified person in accordance with this manual. If it is not installed correctly, the door may fall and cause injury.
- Provide a frame that can withstand the weight and impact of opening and closing the door. Be sure to use the specified screws and tighten them securely. If the mounting strength is insufficient, the door may fall and cause injury.







- Do not use this product for any other purpose, or with doors that are outside the specifications of this manual.
- Do not disassemble or modify any parts other than those described in this document.



Caution: If not followed, injury or damage may result.

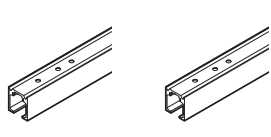
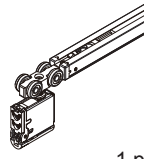

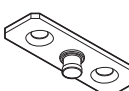
- Follow the specified dimensions, specifications, and alignment of the door and frame. Warping, tilting or twisting of the frame or door may cause failure.
- If cutting any parts, make sure to remove any burrs before installation. Also check the upper track for any left-over burrs or scraps and remove these.
- This product is a part for architectural fittings. After installation, please check the function and safety of the final product. Please inform the end user how to use the product safely.
- Make sure to check the screws for slack at regular intervals (one month from first usage, half a year, and then one time every year is recommended).
- Install the product with two people (in the case of one person, there is a risk of damaging components).

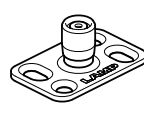
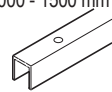
COMPONENT PARTS

No.	①	②	③	④	⑤	⑥	⑦
Name	Upper track	Soft closer (two way)	Upper roller	Front trigger	Pocket trigger	Floor guide	Embedded Lower Guide Rail
Order code	Various length & finishes	250-056-001	250-056-002	250-029-707	250-029-706	250-029-718	250-019-971
Part No.	FD50-TRP	FD50SP-WRH-DSC	FD50SP-WRH	FD50-TRGPF	FD50-TRGPB-HB	FD50-BGR18	FD30-HBRT
Parts		 1 pc	 1 pc	 1 pc	 1 pc	 1 pc	 1000 - 1500 mm Hole pitch : 250 mm Pitch end : 30 mm 1 pc
Accessories	Countersunk head tapping screws 4 x 40 (Q'ty depends on the hole location)	Flat head tapping screws 3.8 x 40 3 pcs	Flat head tapping screws 3.8 x 40 3 pcs	Countersunk head tapping screws 4 x 40 2 pcs	Countersunk head tapping screws 4 x 40 2 pcs	Countersunk head tapping screws 4 x 20 4 pcs	Recommended screw : Countersunk head tapping screws 4 x 20

Options	No.	⑧	⑨
	Name	Cover cap	Spanner wrench
	Part No.	FDSP-WRH-CP	FDSP-SP
Parts			

✗ FD50SP Below parts which are packed with soft closer ② are not needed for this application.

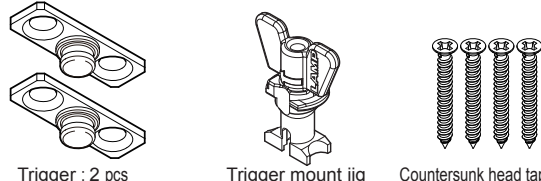

Trigger : 2 pcs
Trigger mount jig
Countersunk head tapping screws 4x30 D6 : 4 pcs

INSTALLATION DRAWING (EXAMPLE)

The example shows the sliding door when the leading edge (at the fully opened position) is aligned with the connecting position of the upper tracks. To shift the connecting position towards the trailing edge, see page 9.

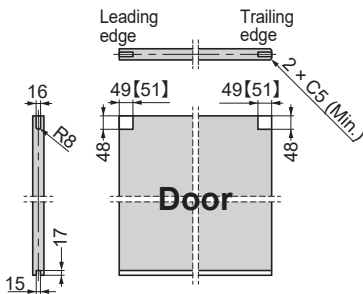

Door process dimension
[] show the dimensions when using Cover caps⑧.

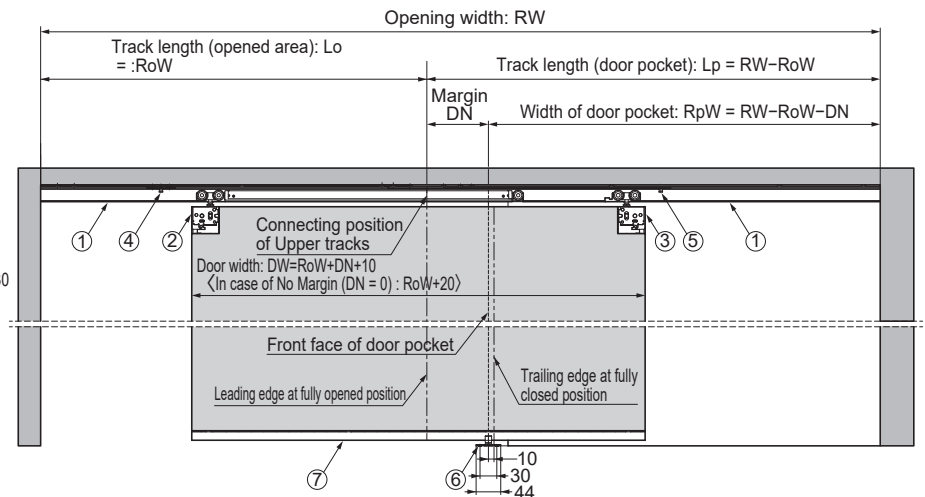
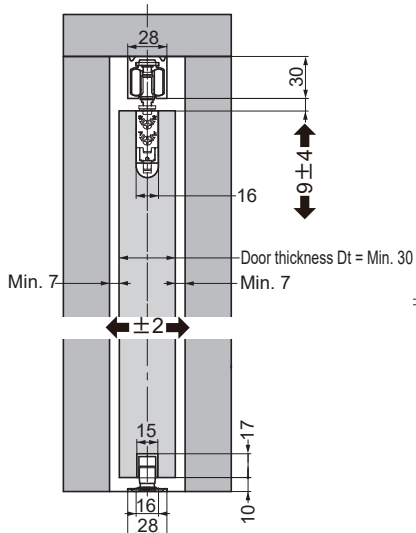
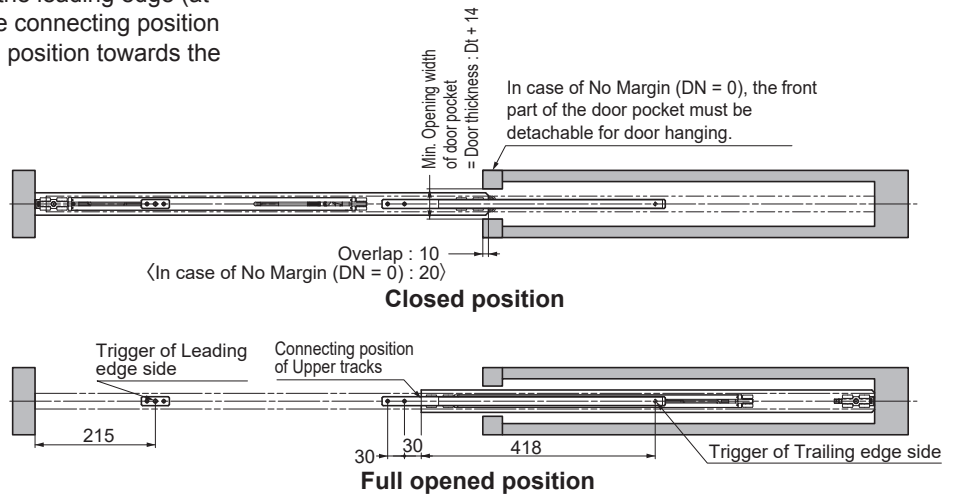

TOOLS REQUIRED FOR INSTALLATION

- Philips head driver #2
- Machine or tool for cutting aluminum ally
- Drill bit for metal: $\phi 5$
- Drill bit for metal (for $\phi 9.6$ countersunk hole)

INSTALLATION PROCEDURE

1 Cutting and Hole Drilling on Upper Track

Caution
When cutting, reinforce the track to prevent deformation at the cut section.

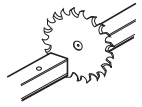

Caution
Do not cut the track on the side with three holes.

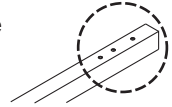

When using 1260 mm track

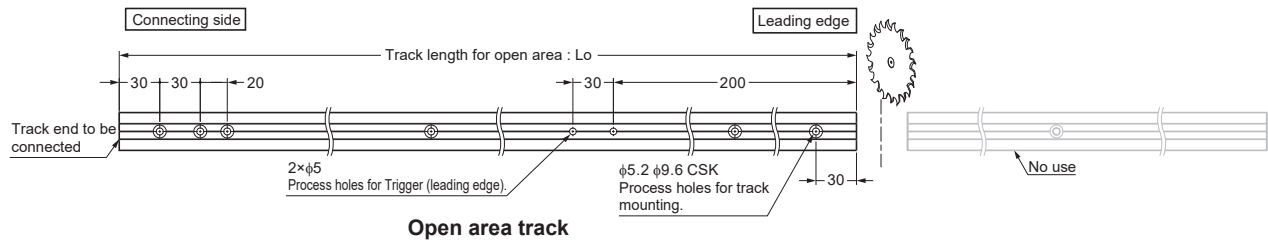

When cutting from a long track (1860 mm, 2760 mm & 3960 mm)

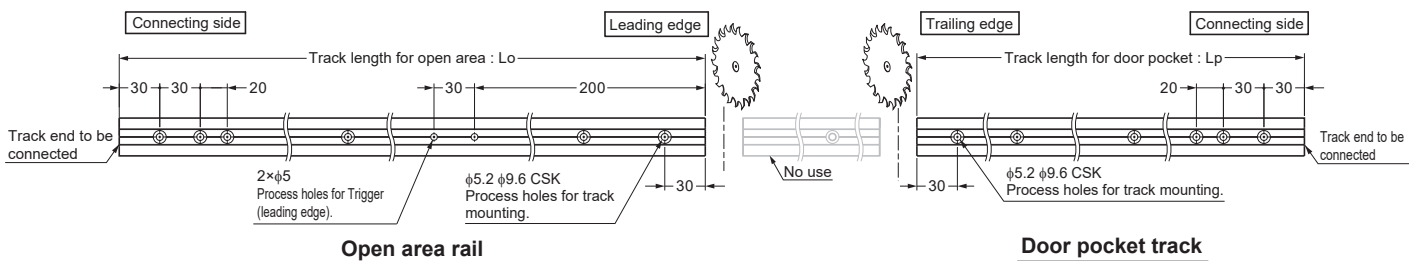

2 Installing Door Pocket Track

Caution
Remove any dirt or aluminum chips from the track.

Caution
Install the cover panel onto the door pocket after mounting the track.

The end which has three countersunk holes must face the center.

Door pocket track

① Countersunk head tapping screws 4 x 40 (provided)

3 Preparation of Mounting Parts

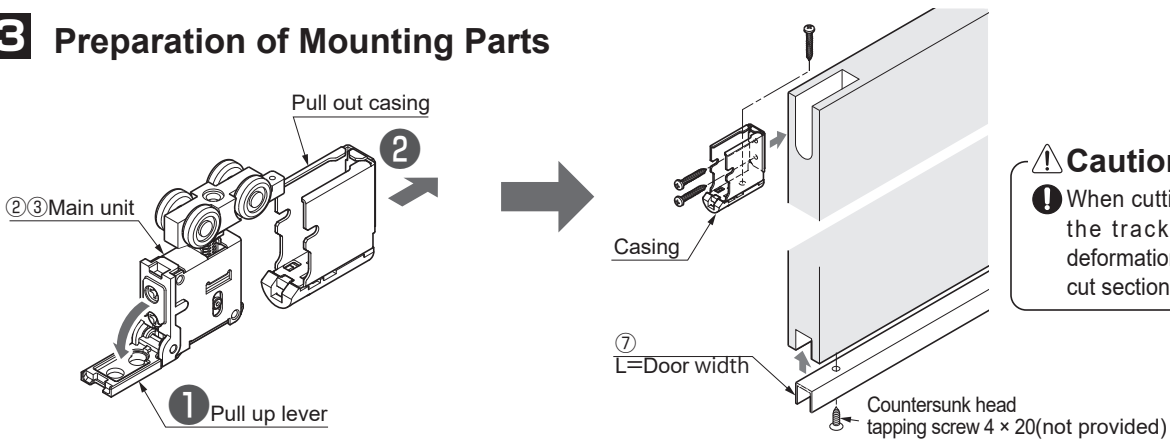

Caution

When cutting, reinforce the track to prevent deformation at the cut section.

4 Installing Pocket Trigger

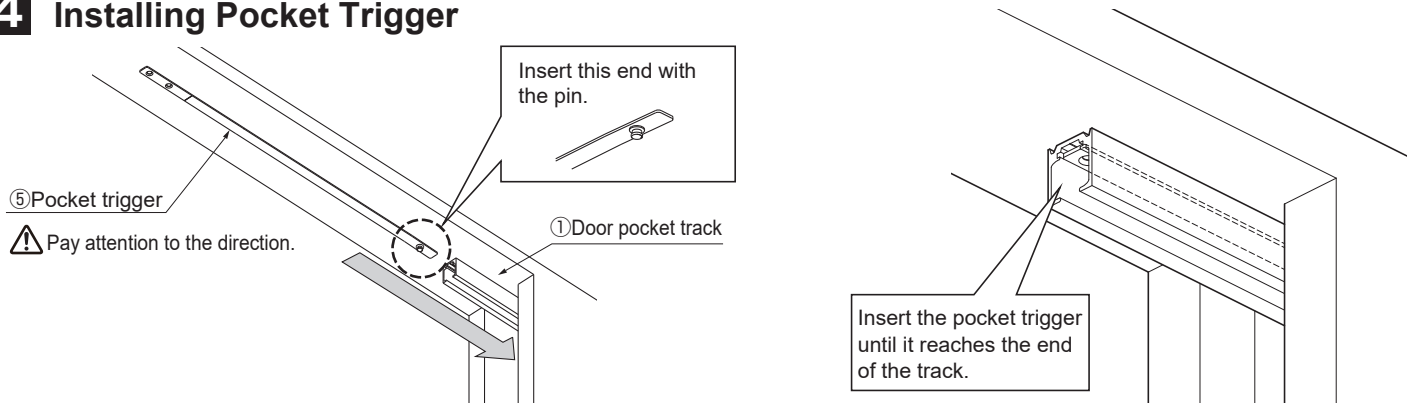

5 Verification Before Installing Soft Closer

Caution

Without verification the self closing feature may fail.

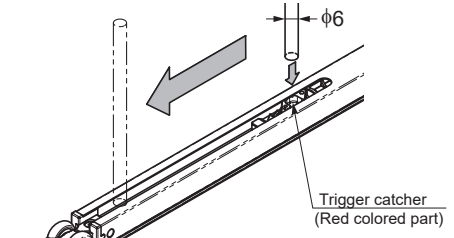
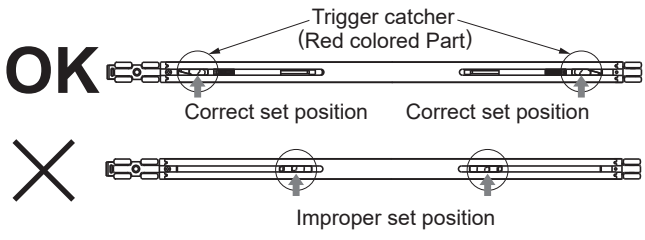

If the trigger position is wrong, pull back the trigger catcher to the correct position using a 6 mm diameter hard bar.

6 Inserting Parts into Open Area Track

Insert the parts in order from ① to ③.
You can insert the parts smoothly from the connecting end which has no burrs.

Caution

Remove any dirt or aluminum chips from the track.

Tape around rollers and upper track to prevent inserted parts from falling.

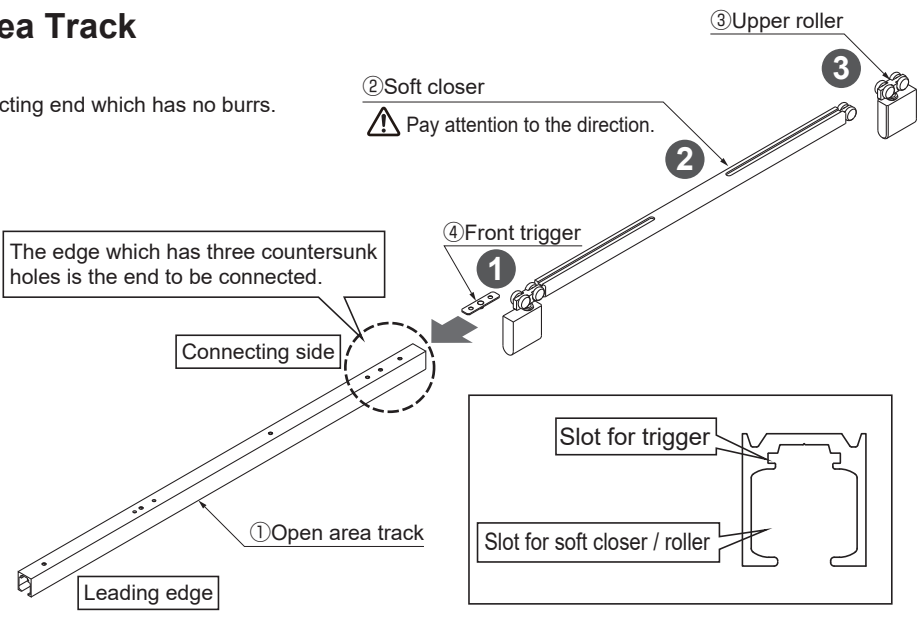

7 Mounting of Open Area Track

[1] Connecting to door pocket track.

Align the track end to the end of the door pocket track.

Pull out the pocket trigger from the door pocket track, and insert it into the open area track.

⚠ Caution

- ❗ Remove any dirt or aluminum chips from the track.

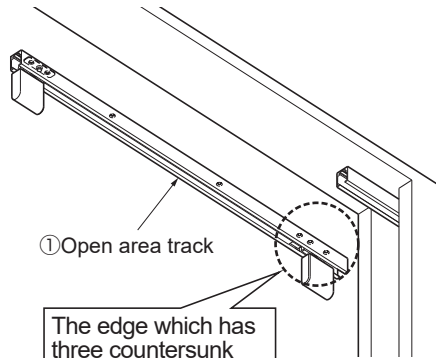

⚠ Caution

- ❗ Overlap the two countersunk holes on the pocket trigger and the two holes on the open area track. Deviation of the joint position makes insertion of the trigger difficult.

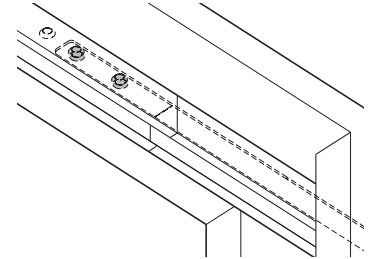

⚠ Caution

- ❗ When sliding the pocket trigger, use a screwdriver. The screwdriver may unexpectedly come out and damage the track. Scratches on the running track may cause a noise of rollers during operation.

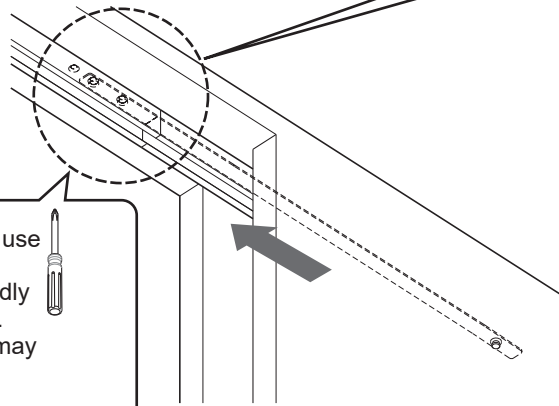

[2] Fastening trigger and track

Fasten the open area track and pocket trigger with provided screws in order of ① to ⑤. Move rollers if they cover the fastening holes on the track.

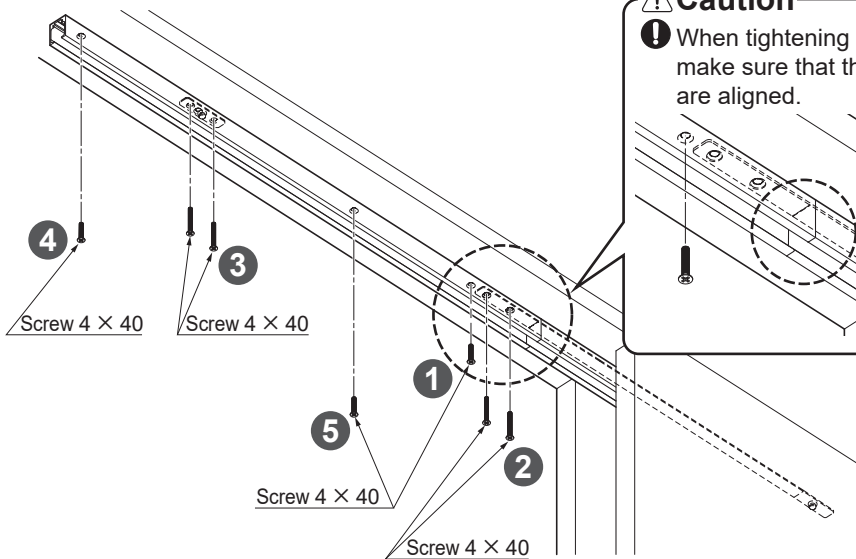

⚠ Caution

- ❗ When tightening the ① screws make sure that the both tracks are aligned.

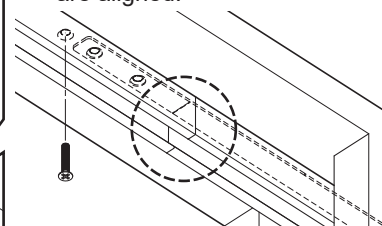

⚠ Caution

- ❗ Be careful not to misalign the tracks. Tighten the screws firmly.

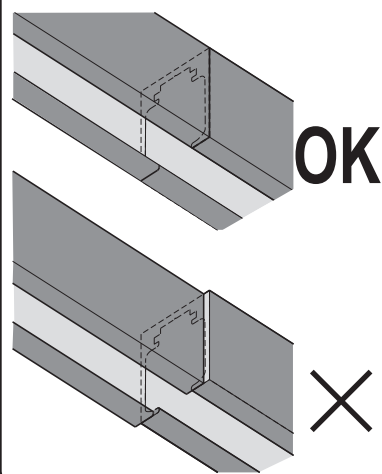

⚠ Caution

- ❗ After fixing the track, move rollers and check if there is any misalignment or gap between the tracks.

8 Mounting of Floor Guide Temporarily

Position floor guide just below the center of the upper track.

Caution
 ⚠ The position of the model where the margin occurs is shown in the figure.

Temporarily fasten through the slotted holes with the provided screws.

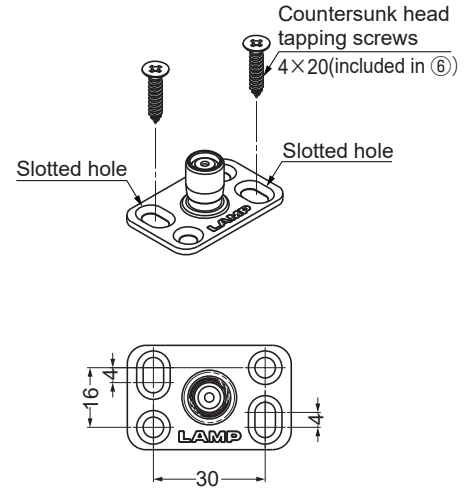
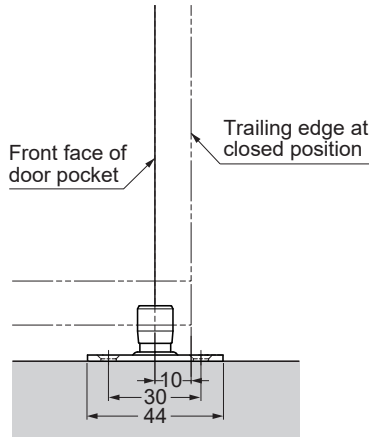
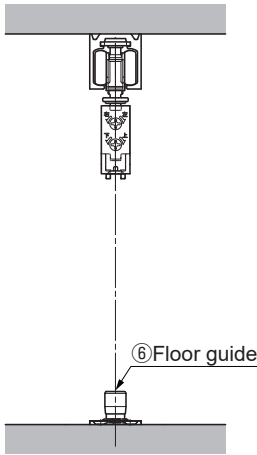

9 Hanging Door

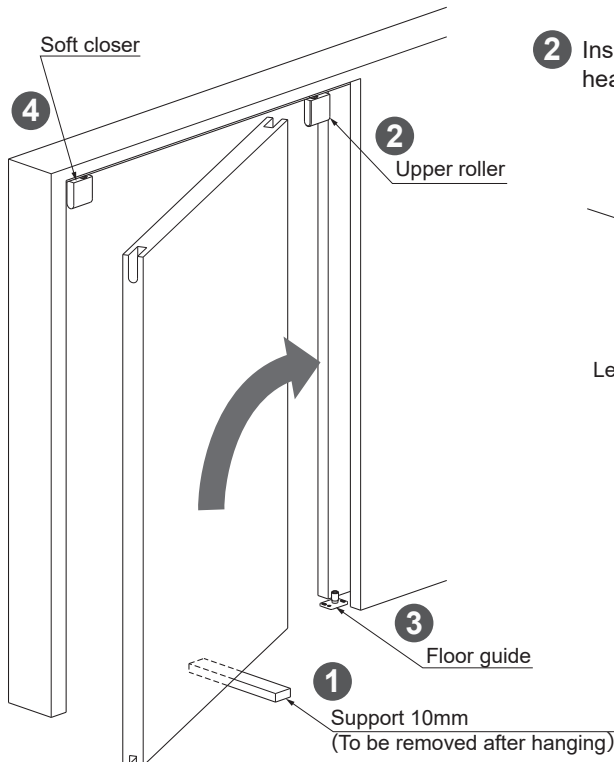

2 Insert the roller until a click sound is heard.

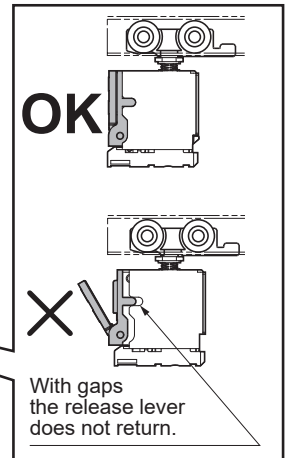
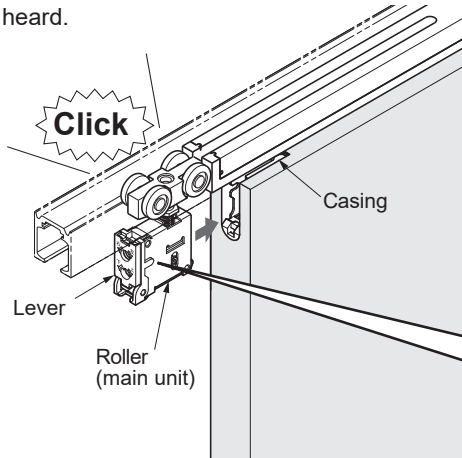

Caution
 ⚠ Verify that the main unit is not dislocated from the casing, for either of the door ends.

5 Verification of Soft Closer Operation

● Starting point of soft - close : approx. 115 mm before the final position.

10 Adjusting the Door Position

Adjust the door so that it is parallel to the upper track with 6-14 mm of clearance between the door and floor.

⚠ Caution

- ❗ The adjustment of the door should be done with the jump prevention nut loosened.

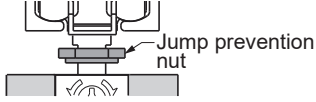

- ⊘ Do not turn the adjustment screw beyond adjustment range.

- ⊘ Do not use electric screw driver.



Vertical adjustment range: 8 mm

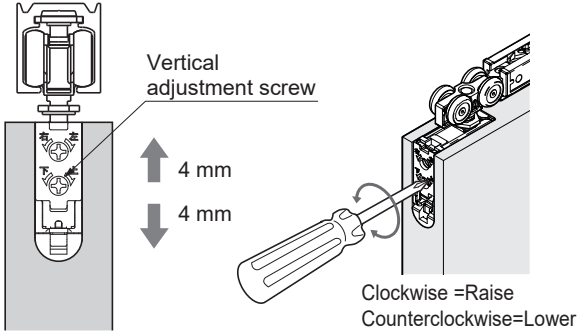

Depth adjustment range: 4 mm

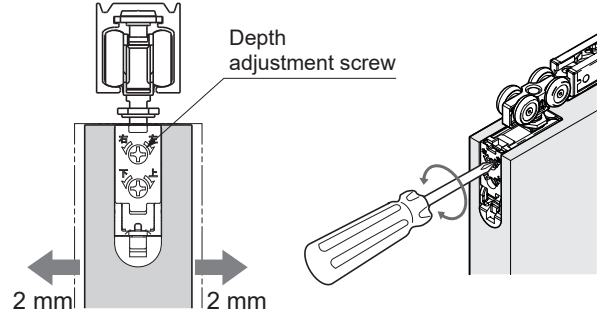

11 Adjusting , Fastening Floor Guide

If the door movement is not smooth, remove the door, then adjust the floor guide forwards or backwards.

Tighten all 4 screws after the adjustment.

Adjustment range: 4 mm

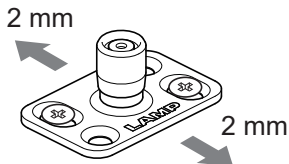

Countersunk head tapping screws
4 × 20

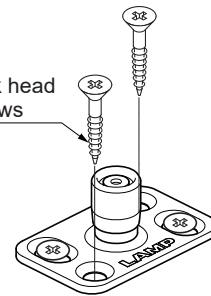

12 Fastening the Jump Prevention Nut

The jump prevention nut is on the hanger bolt of the upper roller.
Tighten the nut with the provided spanner wrench until it contacts the soft closer.

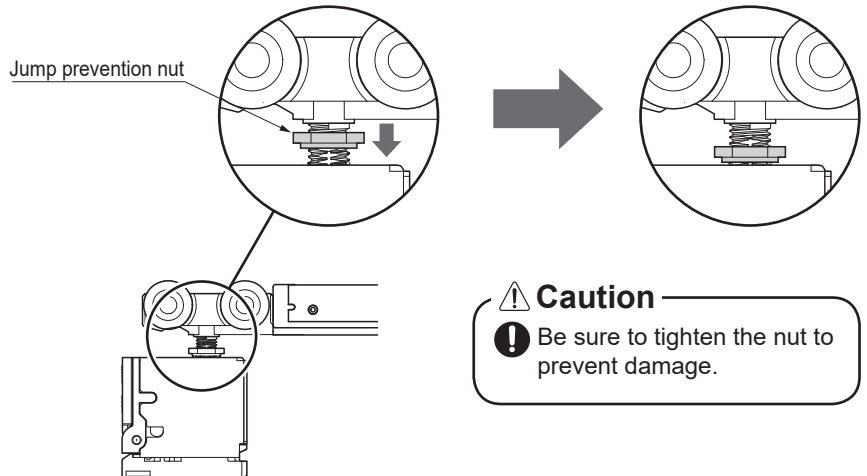
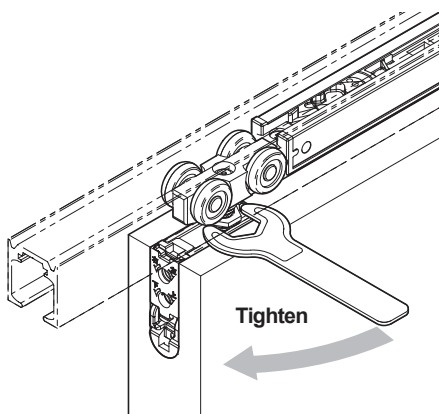

⚠ Caution

- ❗ Be sure to tighten the nut to prevent damage.

Appendix 1 How to Remove Door, Track

[1] How to remove door

- ① Use a 10 mm support under the door.
- ② Then pull out the upper roller main unit from the door while lower the lever. If it is difficult to install or detach the roller, loosen the nut as shown in the illustration. It will be easier if you slide the hanger bolt with a spanner wrench.
- ③ Pull out the door, while making sure not to let it scratch against the door pocket.
- ④ Pull out the trailing edge roller from the casing.

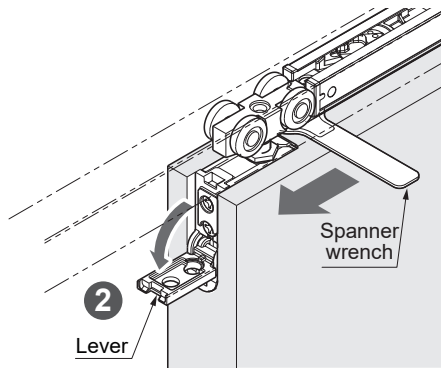

Caution
Be careful not to let the door fall.

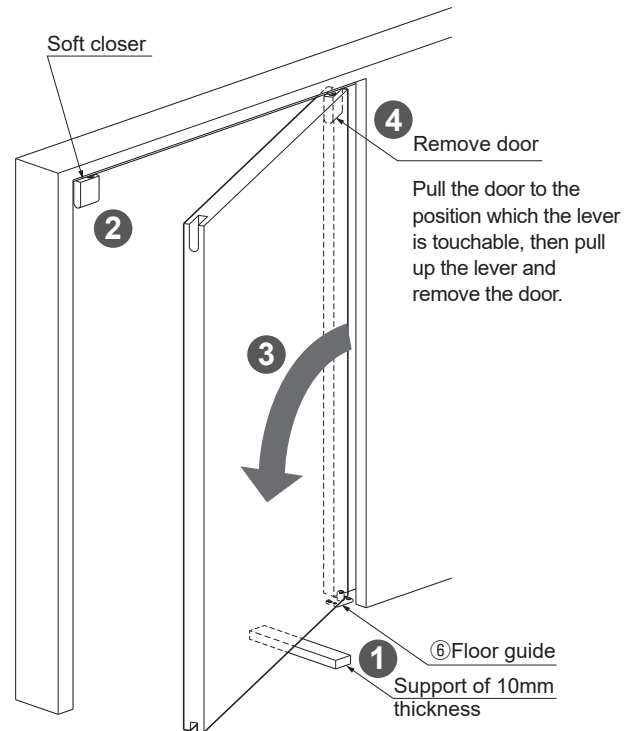

[2] How to remove Upper track

- ① Remove the pocket trigger screws.
- ② Slide the pocket trigger into the door pocket track.
- ③ Remove the open area track.

Caution
The trigger can be deformed if the open area track is removed if the pocket trigger has not been moved into the pocket track.

Hold the open area track when removing the last screw.

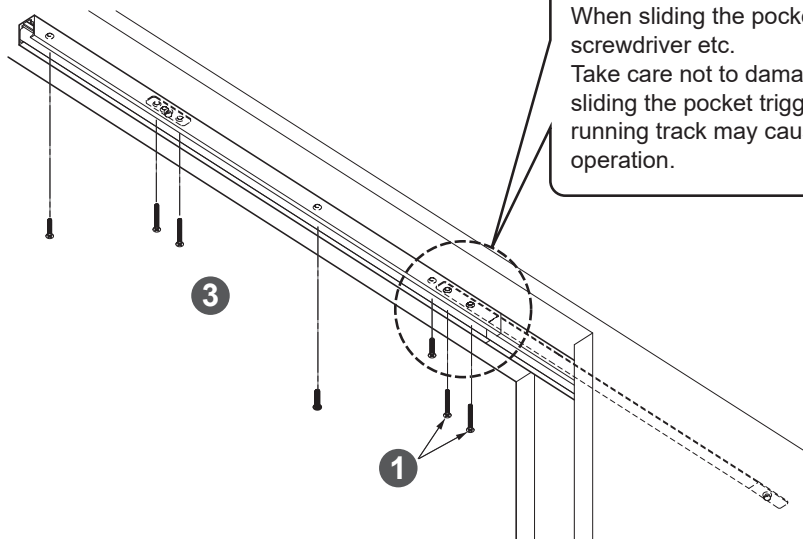

Caution

When sliding the pocket trigger, use a screwdriver etc.
Take care not to damage the track when sliding the pocket trigger. Scratches on the running track may cause roller noise during operation.

Appendix 2 How to Shift the Connecting Position of the Tracks

[1] When determining the trigger position on site

- (1) Put a mark on the open area track with reference to the front end of the door at the fully opened position.
(Use masking tape so that the track isn't marked)
- (2) Remove the open area track.
Remove the door according to the procedure - **Appendix 1**: How to remove the door, then remove the open area track.
 - Drill additional holes for trigger on the open area track.
(See the drawing below.)

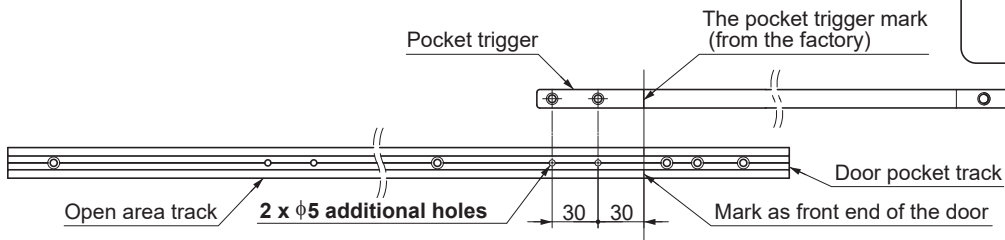
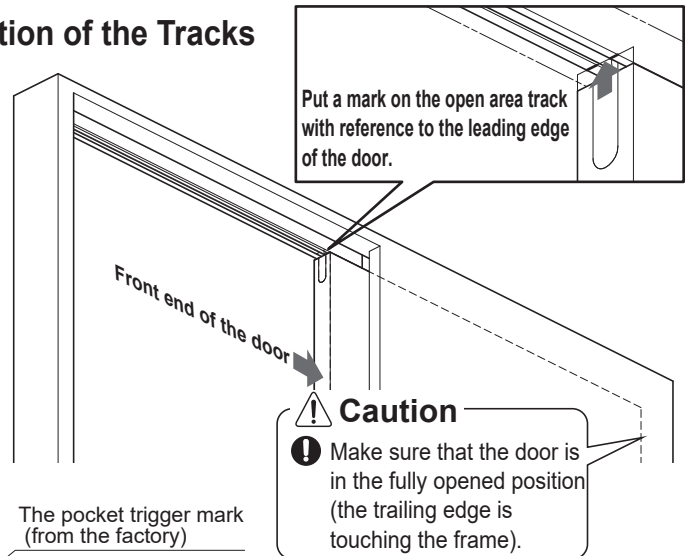

- (3) Mounting open area track
Follow the figure to the bottom right, since the working sequence is different from the regular process.
- (4) Hanging the door
Refer to the procedure [2] and the following procedures on page 3.

Working sequence for mounting the open area track (common to [1] and [2])

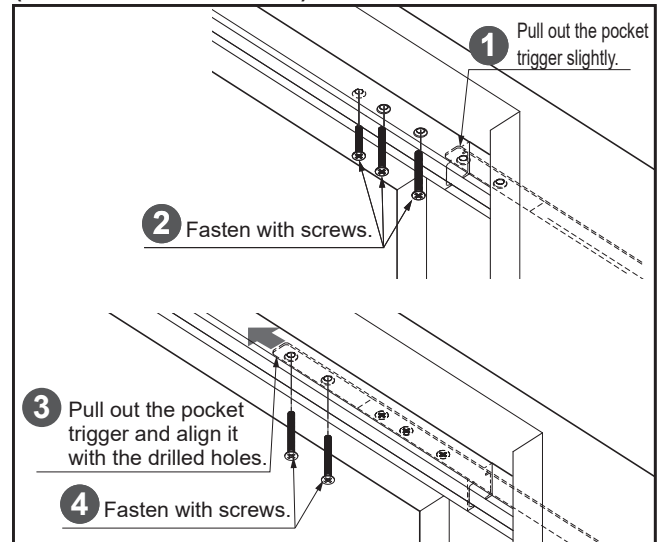

[2] How to process the holes for pocket trigger in advance

[Example] Door pocket track with length equal to the width of the door pocket.

- (1) Drill holes for the pocket trigger according to the drawing below.
- (2) Fix the open area track, while following the above right figure, since the working sequence is different from the regular process.

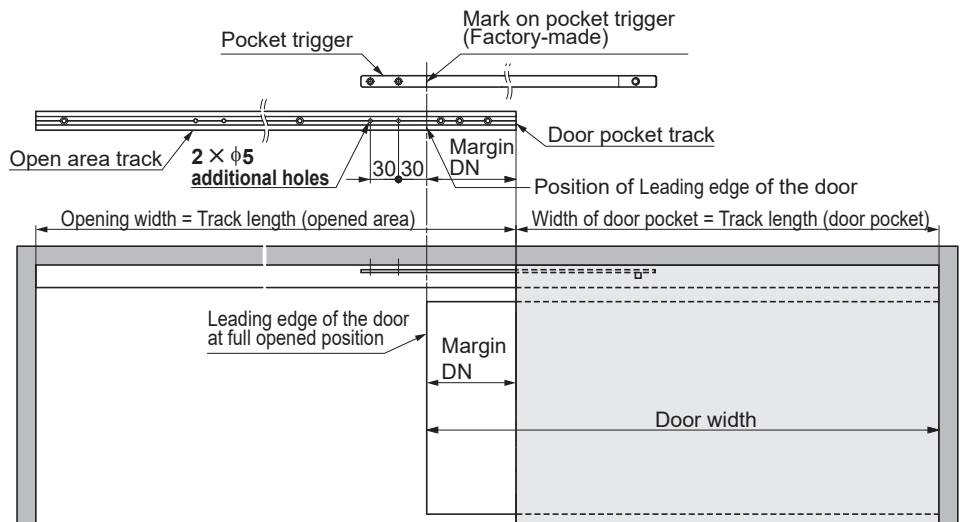

PERIODICAL INSPECTION

- Clean the inside of the track.
- Check the upper and lower space of the door. If necessary, correct the space.

TROUBLESHOOTING

Trouble	Checkpoint	Solution
Door stops during soft closing	Check if door bottom contacts the floor or floor guide.	Verify that the track fixing screws are not loosened. Then, adjust the door height such that the clearance between the door bottom and floor is 6 - 14 mm.
	Check if the upper track is set horizontally.	Using a level gauge, reset the upper track horizontally.
	Check if mohair seal is installed.	Reduce the friction between the mohair seal and door.
The door doesn't close softly.	Check if trigger is installed.	Install trigger to specified position.
	Check if door is closed by excessive force.	Do not close door by excessive force as it may damage the soft closer.
	The position of trigger catcher in page 4 section 5 may become dislocated. (It is hidden as installed in upper track.)	Remove the door and the upper track, then check the status of the trigger in section 5.
Abnormal noise during operation	Check if door bottom contacts the floor or floor guide.	Verify that the track fixing screws are not loosened. Then, adjust the door height such that the clearance between the door bottom and floor is 6 - 14 mm.
	Check if door touches adjacent parts.	Adjust position of the floor guide.
	Check track rollers for aluminum dust.	Remove the track, then pull out and clean the roller.
	Check the track mounting screws for looseness.	Retighten the screws to free the roller.
Heavy door operation	Check if door bottom contacts the floor or floor guide.	Verify that the track fixing screws are not loosened. Then, adjust the door height such that the clearance between the door bottom and floor is 6 - 14 mm.
	Check if door touches adjacent parts.	Adjust position of the floor guide.
Door does not move.	Check the track retaining screws for looseness.	Retighten screws to free the roller.
Door starts to move.	Check if the upper track is set horizontally.	Using a level gauge, reset the upper track horizontally.
Door stops or caught during operation.	Check if there is any gap or misalignment between the tracks.	Correct the misalignment or gap.

SUGATSUNE KOGYO CO., LTD.
Tokyo, JAPAN
Phone: +81 3 3866 2260
E-mail: export@sugatsune.co.jp

SUGATSUNE KOGYO (UK) LIMITED
Reading, UK
Phone: +44 1189 272 955
E-mail: sales@sugatsune.co.uk

SUGATSUNE EUROPE GmbH
Düsseldorf, GERMANY
Phone: +49 211 53612 900
E-mail: sales@sugatsune.eu

SUGATSUNE AMERICA, INC.
California, USA
Phone: +1 310 329 6373
E-mail: sales@sugatsune.com

Chicago, USA
Phone: +1 630 317 7072
E-mail: sales@sugatsune.com

SUGATSUNE CANADA, INC.
Montreal, CANADA
Phone: +1 514 312 5267
E-mail: support@sugatsune.ca

SUGATSUNE SHANGHAI CO., LTD.
Shanghai, CHINA
Phone: +86 21 3632 1858
E-mail: lamp@sugatsune.com.cn

Guangzhou, CHINA
Phone: +86 20 6639 3554
E-mail: lamp@sugatsune.com.cn

SUGATSUNE KOREA CO., LTD.
Incheon, KOREA
Phone: +82 32 220 0603
E-mail: sales@sugatsune-korea.co.kr

SUGATSUNE KOGYO INDIA PRIVATE LIMITED
Mumbai, INDIA
Phone: +91 9867299597
E-mail: sales@sugatsune.in
Delhi, INDIA
Phone: +91 9867299597
+91 11 45093636
E-mail: sales@sugatsune.in