

LAMP[®]

DMF3-B BRACKET FOR DMF3 AND DMFH3 INSTALLATION MANUAL

Thank you for selecting our product. Before starting installation, please read this manual thoroughly to ensure correct installation. Please keep this manual at hand for future reference.

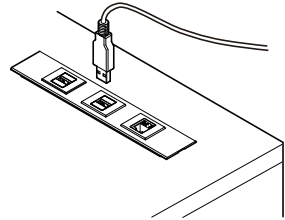

Cover is not included.

ABOUT THE PRODUCT

- Mounting bracket for DMF3 and DMFH3.
- Various connectors such as LAN connector, USB connector, and enclosed type cable case can be assembled.

SPECIFICATIONS

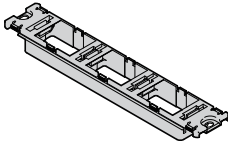

■ Screw

Wood mounted : Binding head tapping screw 4×16···2 pcs (Included)
 Metal mounted : Binding screw M4, Nut M4, and Plain washers Nominal Size4 (Not included)

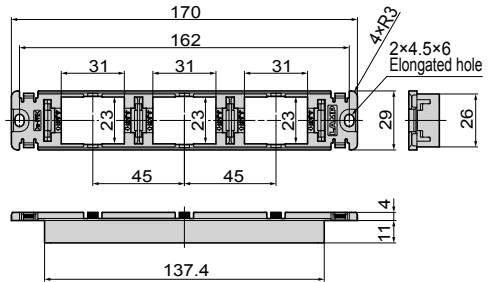

Item Code	Item name	Number of slots
210-040-778	DMF3-B	3

PRECAUTIONS FOR SAFETY

Precautions for installation

- ⚠ **Caution** If not followed injury or damage may result.
- ❗ It is necessary to mount the product on the place which can hold the weight of the installed parts and can bear the operating force of connectors.

Precautions for use

- ⚠ **Caution** If not followed injury or damage may result.
- ⊘ Do not paint the product to avoid damage.

INSTALLATION

1 Drilling dimensions

Surface mounted

For DMF3

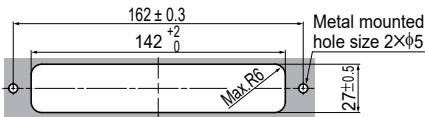

Recessed mounted

For DMFH3

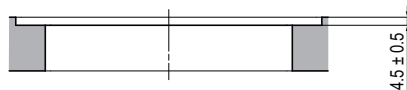
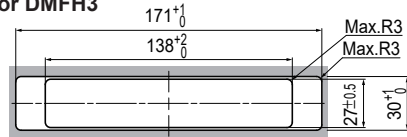

2 Assembly

[1]

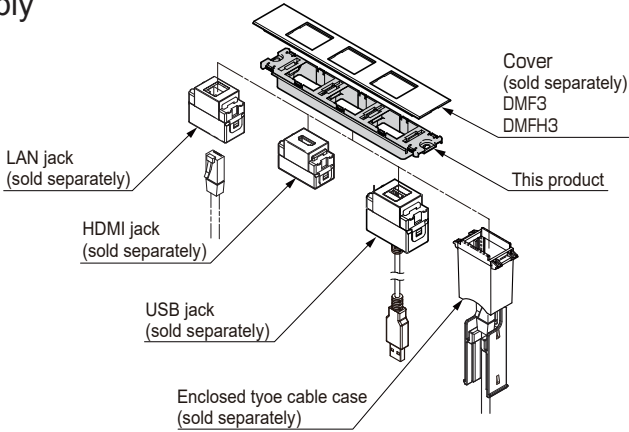

[2] Starting from either end, Hook the jack onto the lip of the bracket and push until a click sound is heard.

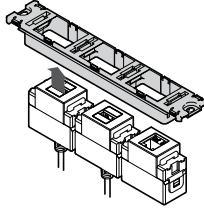

Removal of jack

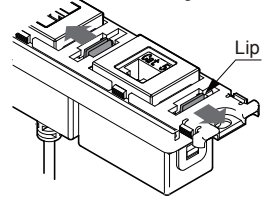

Remove bracket from furniture.

- ① Hold the jack from back side.
- ② Pry either of the bracket lips away from the jack.
- ③ Remove the jack from the back side.

⚠

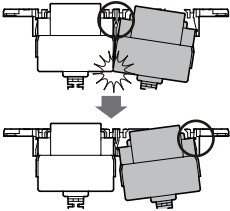

If there is interference with an adjacent component hook the jack claw on the opposite lip.

[3] Mounting.
(For recessed mounted models)

Provided screws

Metal mounted: (screws not included) refer to the Screw section on page 1.

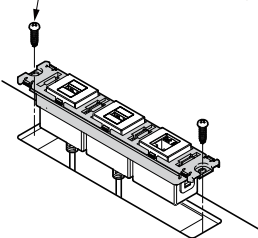

[4] Push the cover in until a click sound is heard, Leave no gap between the cover and tabletop.

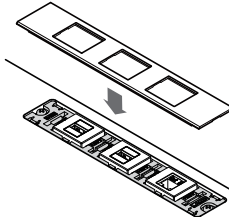

Removal of cover

Insert a flat-head screwdriver into either of the gaps () between the cover and tabletop. Pry to remove the cover.

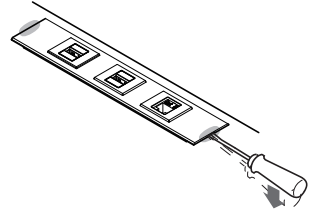

2

SUGATSUNE

SUGATSUNE KOGYO CO.,LTD
Tokyo, JAPAN

Manufacturer of **LAMP** brand Products

Phone: +81 (0)3 3866 2260 E-mail: export@sugatsune.co.jp

2020.02 1235-3