

LAMP® FD30-F FOLDING DOOR SYSTEM

Installation Manual

(Additional Door)

Part No.FD30UP

Thank you for selecting our product. Before starting installation, please read this manual thoroughly to ensure correct installation. Please keep this manual at hand for future reference.

ABOUT THE PRODUCT

- This product is parts set for pivot door system for indoor use.
- Easy door installation and adjustment.

SPECIFICATION

Max.Door width	450 mm
Max.Door height	2400 mm
Min.Door thickness	30 mm
Max.Door weight	15 kg / door
Height adjustable range	± 4 mm

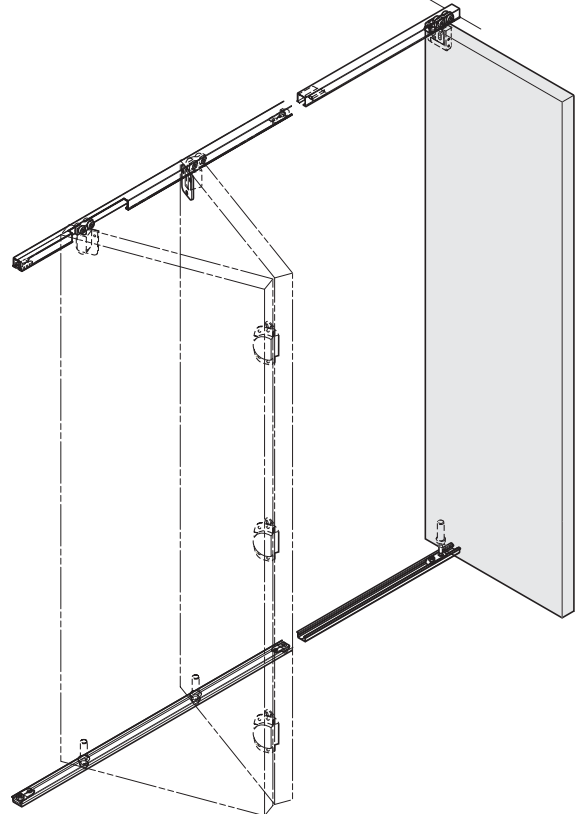

Above describes a combination example of folding door FD30UMP(slidable folding).

FOR YOUR SAFE WORK AND CORRECT INSTALLATION

Meaning of symbols

Warning Caution	Prohibited	Required
--------------------	------------	----------

WARNING: If these warnings are not followed, it may result in death or serious injury.

- ❗ This (folding door system) should be installed by an experienced person who has correct knowledge. If the system is not installed correctly, the door will not operate smoothly, and or may cause injury.
- ❗ It is necessary to manufacture the frame with sufficient strength so it endures the weight of the door and impact shocks upon opening/closing the door. A frame with poor strength might result in improper and slower movement of the door. In the worst case, the door might drop down and cause injury.
- ⊘ Do not try to use this product for any other purposes other than originally intended for. Do not use the parts for applications that are out of specification.
- ⊘ Do not disassemble nor modify any parts than those described in this document.

Caution: If these cautions are not followed, it may result in injury or damage.

- ❗ Make sure to follow the designated measurements and specifications as well as horizontal and verticals angles. Make sure that the frame is not warped, since it may affect the movement of the door.
- ❗ If cutting any parts, make sure to remove any burr before installation. Also check the upper track for any left-over burr or scrap and remove these.
- ❗ This folding door system is a part for furniture fittings. After installation, make sure to test the finished product thoroughly to ensure that it is well-functioning and safe.
- ❗ Make sure to test the screws for slack at regular intervals (one month from first usage, half year and then one time every year is recommended).
- ⊘ Do not open / close the door with excessive force as this may result in damage.

COMPONENT PARTS (PER BOX)

No.	①	②	③	④	⑤	⑥	⑦
Name	Upper roller	Cover cap	Bottom pivot	Pivot insert Jig	Spanner	Fixing plate	Pivot bracket (bottom)
Item No.	FD30-WRH	FD30-WRH-CP	FD30-FBP	FD30-FSJ	FD30-FSP	FD30-FKK	FD30-FSK
Item							
Attached screw	Tapping screw 3.5x30 3 pcs	—	—	—	—	—	—
	1	1	1	1	1	1	1

No.	⑧	⑨		⑩	
Name	Magnet catch	Upper track (Surface mount)	Upper track (Recessed mount)	Bottom guide track (Surface mount)	Bottom guide track (Recessed mount)
Item No.	FD-30-FMC	FD30-TRM	FD30-TRH	FD30-FBRM	FD30-FBRH
Item					
Recommended screw	Flat hard wood screw 3.5x20	Tapping screw 3.5x20		Tapping screw 3.5x16	
	1	Use1(surface mount or recessed)		Use1(surface mount or recessed)	

INSTALLATION DRAWING (EXAMPLE)

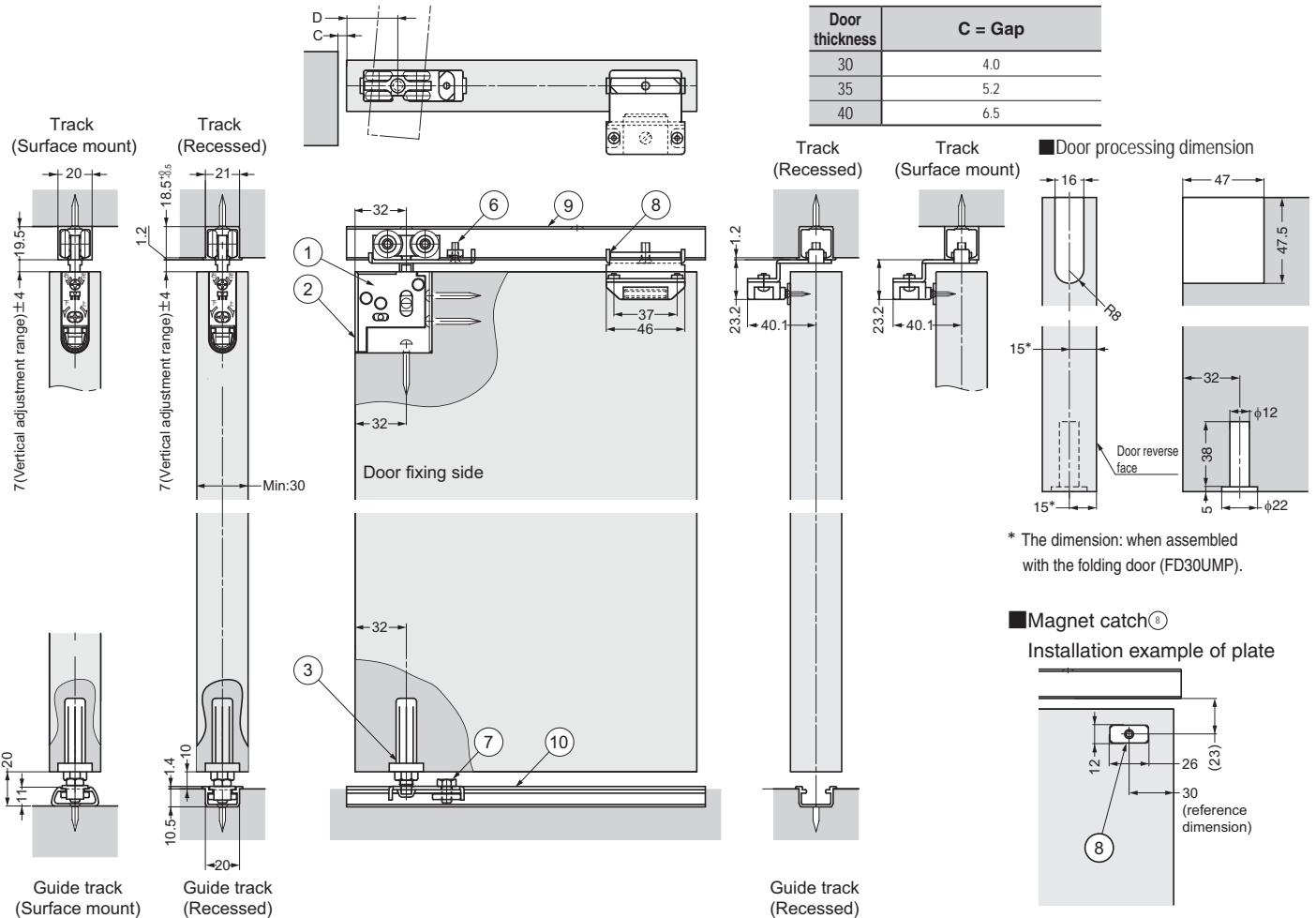

1 Cutting Track

Cut the track 1 applying a reinforcer to prevent deformation of cut section.

Caution
Remove any dirt or chips from the tracks.

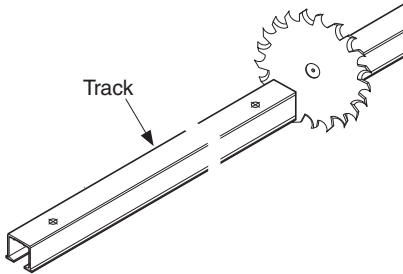

2 Removing Casing

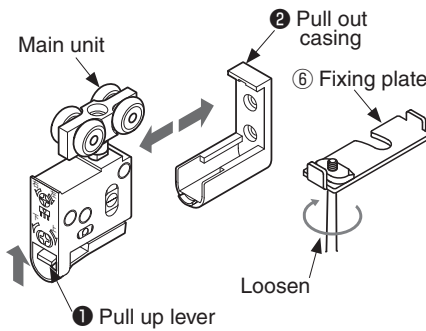

3 Installing Casing

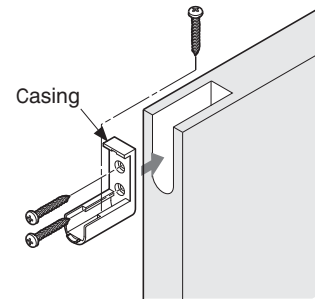

4 Assembly of Parts

Assemble fixing plate 6 to the hanger bolt of upper roller 1. Then insert the parts with care of direction.

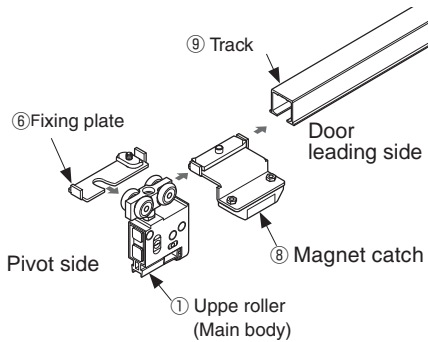

5 Installing Bottom Pivot

Caution
Be careful not to damage the plastic part of bottom pivot.

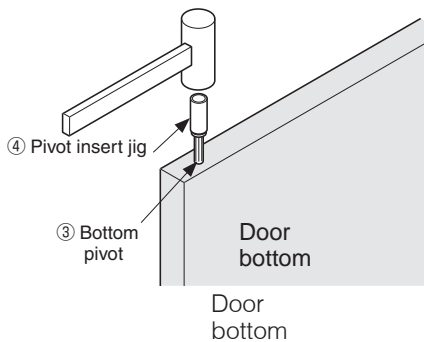

6 Installing Pivot Bracket

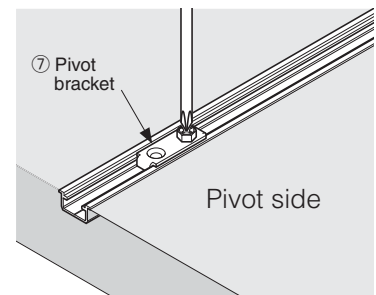

7 Installing Door

[1] Fixing plate (temporarily)

Screw the fixing plate temporarily according to installation drawing.

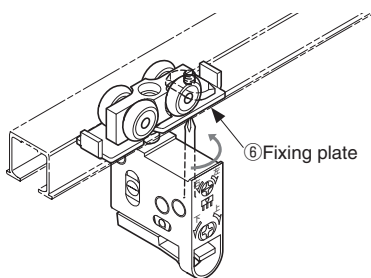

[2] Bottom

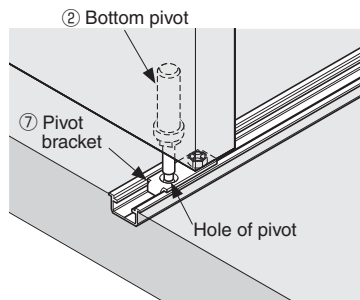

[3] Top

Insert upper roller main unit into the casing installed on door until click sound is heard.

Caution
Confirm that main unit is firmly clipped in the casing.

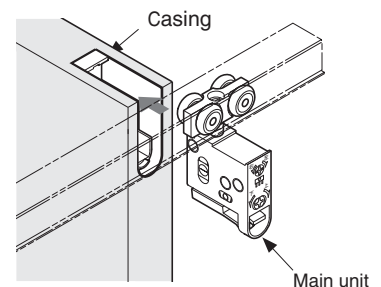

8 Confirmation of Door Movement and Adjustment

Move the door slowly. If the movement is not smooth, adjustment may be needed to correct door position.

[1] Adjusting inclination of door

Loosen the screws on fixing plate and pivot bracket to make the door vertical. Then retighten the screws.

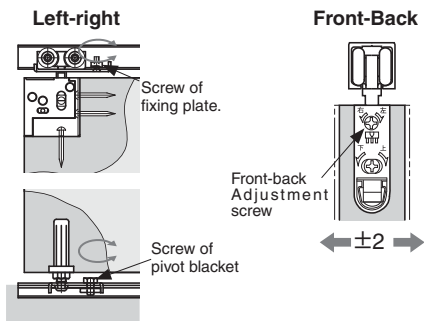

[2] Adjusting vertical position

Turn the nut on bottom pivot with spanner to adjust vertical position, then adjust the screw on upper roller.

Caution
Do not turn adjustment screw beyond adjustment range.
Do not use electric screwdriver.

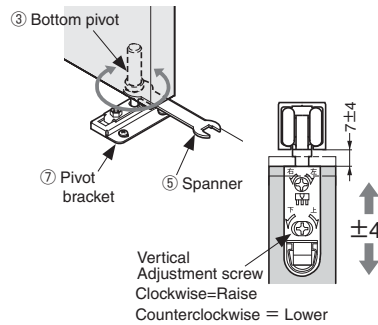

[3] Magnet catch

Adjust the position of magnet catch, then fix it with screw. Close the door and adjust the position of strike plate. Then fix it.

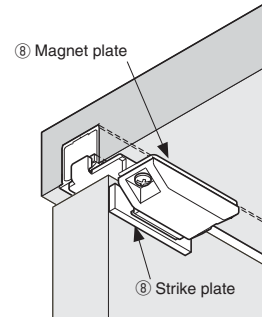

Final confirmation...Confirm that all screws are securely tightened. And, confirm that all screws are used without mistake.

PERIODICAL INSPECTION	<ul style="list-style-type: none"> • Clean inside of track. • Check upper space and lower space of the door. If necessary, correct the space.
------------------------------	---

TRUBLESHOOTING

Trouble	Check	Solution
Abnormal noise during operation	Check if door touches adjacent parts.	In order to prevent door scraping, adjust clearance under fix metal and support metal.
Heavy door operation	Door bottom touches the floor.	Confirm that screws on the rails are not loosened. And, adjust door height. Adjust the clearance between door bottom and floor to 10 mm. (20 mm : Surface mount guide rail)
	Check if door touches adjacent parts.	Correct door position to avoid contact to other objects. Adjust position of lower guide or stopper.
	Check if door is warped.	Use the door without warp.
Door starts to move.	Check if center of lower pivot shaft is aligned with upper roller.	Adjust to align both centers (upper roller and pivot shaft center).
	Check if the upper track is set horizontally.	Using a level gauge, reset upper track horizontally.

SUGATSUNE KOGYO CO.,LTD
Tokyo, JAPAN
Phone: +81 (0)3 3866 2260 E-mail:export@sugatsune.co.jp
SUGATSUNE KOGYO (UK) LTD
Reading, UK
Phone: +44 118 9272 955 E-mail:sales@sugatsune.co.uk

SUGATSUNE EUROPE GmbH
Düsseldorf, GERMANY
Phone: +49 211 53812900 E-mail:sales@sugatsune.eu
ISO9001(Japan Offices and Sugatsune America) and ISO14001(Chiba Production division and Logistics center), certified.

SUGATSUNE SHANGHAI Co., LTD
Shanghai, CHINA
Phone: +86 21 3632 1858 E-mail:lamp@sugatsune.com.cn
Guangzhou, CHINA
Phone: +86 20 6639 3552 E-mail:lamp@sugatsune.com.cn

SUGATSUNE KOGYO INDIA PRIVATE LIMITED
Mumbai, INDIA
Phone: +91 22 28314490/91 E-mail:sales@sugatsune.in

SUGATSUNE AMERICA, INC
California, USA
Phone: +1 310 329 6373 E-mail:sales@sugatsune.com
Chicago, USA
Phone: +1 312 461 1081 E-mail:chicagoshowroom@sugatsune.com.

SUGATSUNE CANADA, INC.
Phone: +1 514 312 5267 E-mail:support@sugatsune.ca