

LAMP® HG-TQJ100 ADJUSTABLE ONE WAY TORQUE HINGE Installation Instructions

Thank you for selecting our product. Before starting installation, please read this manual thoroughly to ensure correct installation. Please keep this manual at hand for future reference.

Item Name	Torque working Direction	Torque
HG-TQJ100-A	Opening	0-10N·m(0-102kgf·cm)
HG-TQJ100-B	Closing	0-10N·m(0-102kgf·cm)

INSTALLATION PROCEDURE

1 Remove the covers with a screw driver.

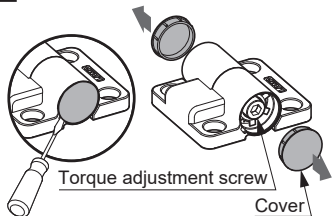

2 Fix hinges with the screws.

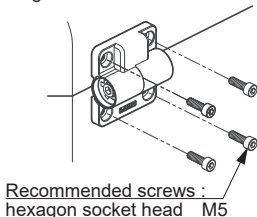

3 Adjust torque so that door stops free

! Caution for torque adjustment screw

- Do not remove.
- Do not overtighten (max. 5.2 N·m)

1 Keep the slotted part in place while adjusting (screw driver recommended).

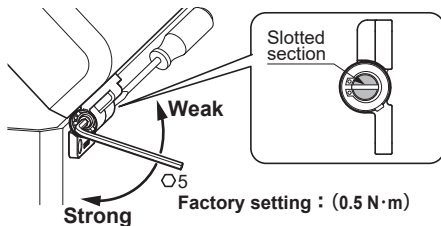

2 Increase torque in small increments evenly on both hinges.

4 Put the covers on the hinges.

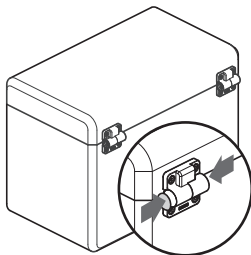

If necessary, re-adjust the torque.