

LAMP® LL-66 LEVER LATCH INSTALLATION INSTRUCTION

Thank you for using our product. Before installation, please read this manual thoroughly to ensure correct installation. Please keep this manual at hand for future reference.

ABOUT THE PRODUCT

- This is a latch for an overlay door indicated in Step 2 in this document, and prevents the door from opening during an earthquake.
- Recommended door size: 700 mm (27") H x 500 mm (20") W

DIMENSIONS

BODY

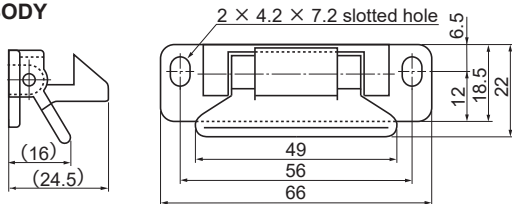

STRIKE PLATE

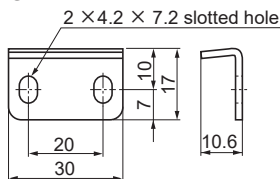

Provided screw: Truss head tapping screw 4x12 4 pcs

BACK SIDE OF CABINET DOOR

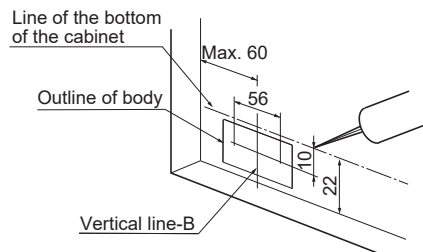

UNDER SIDE OF BOTTOM BOARD

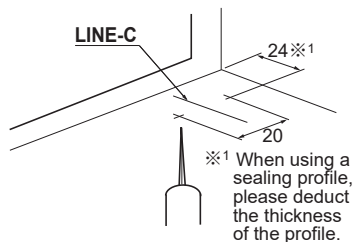

FOR YOUR SAFETY AND CORRECT INSTALLATION

Meaning of symbols



- Warning Caution** If not followed, it may result in injury or damage.
- Prohibited** During an extremely strong earthquake, the doors may open unexpectedly. So do not contain heavy items in the cabinet.
- Required** In the long term use, the door may be warped or may sag, and cause the latch to malfunction. In this case, please re-adjust the position of the latch body and strike plate.

INSTALLATION

Step 1 Mounting of Body and Strike Plate

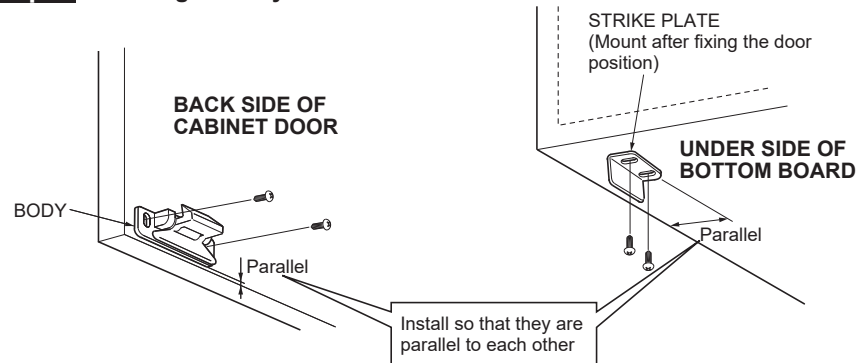

Step 2 Adjustment of Latch body and Strike plate

Adjust the position of the latch body and strike plate as shown below. After the adjustment tighten all of the screws.

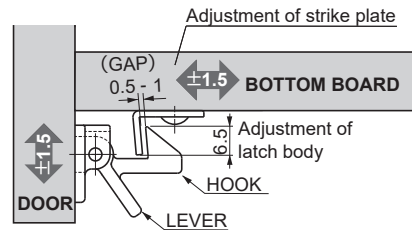

To open the door, pull the lever.

SUGATSUNE KOGYO CO.,LTD
Tokyo, JAPAN
Phone: +81 (0)3 3666 2260 E-mail:export@sugatsune.co.jp

SUGATSUNE EUROPE GmbH
Düsseldorf, GERMANY
Phone: +49 211 53812900 E-mail:sales@sugatsune.eu

SUGATSUNE SHANGHAI Co., LTD
Shanghai, CHINA
Phone: +86 21 3632 1858 E-mail:lamp@sugatsune.com.cn

SUGATSUNE KOGYO INDIA PRIVATE LIMITED
Mumbai, INDIA
Phone: +91 22 28314490/91 E-mail:sales@sugatsune.in

SUGATSUNE AMERICA, INC
California, USA
Phone: +1 310 329 6373 E-mail:sales@sugatsune.com

SUGATSUNE CANADA, INC.
Chicago, USA
Phone: +1 312 461 1081 E-mail:chicago@showroom@sugatsune.com

ISO9001 (Japan Offices and Sugatsune America) and ISO14001 (China Production division and Logistics center), certified.